

RIGHT HAND ROTATION.

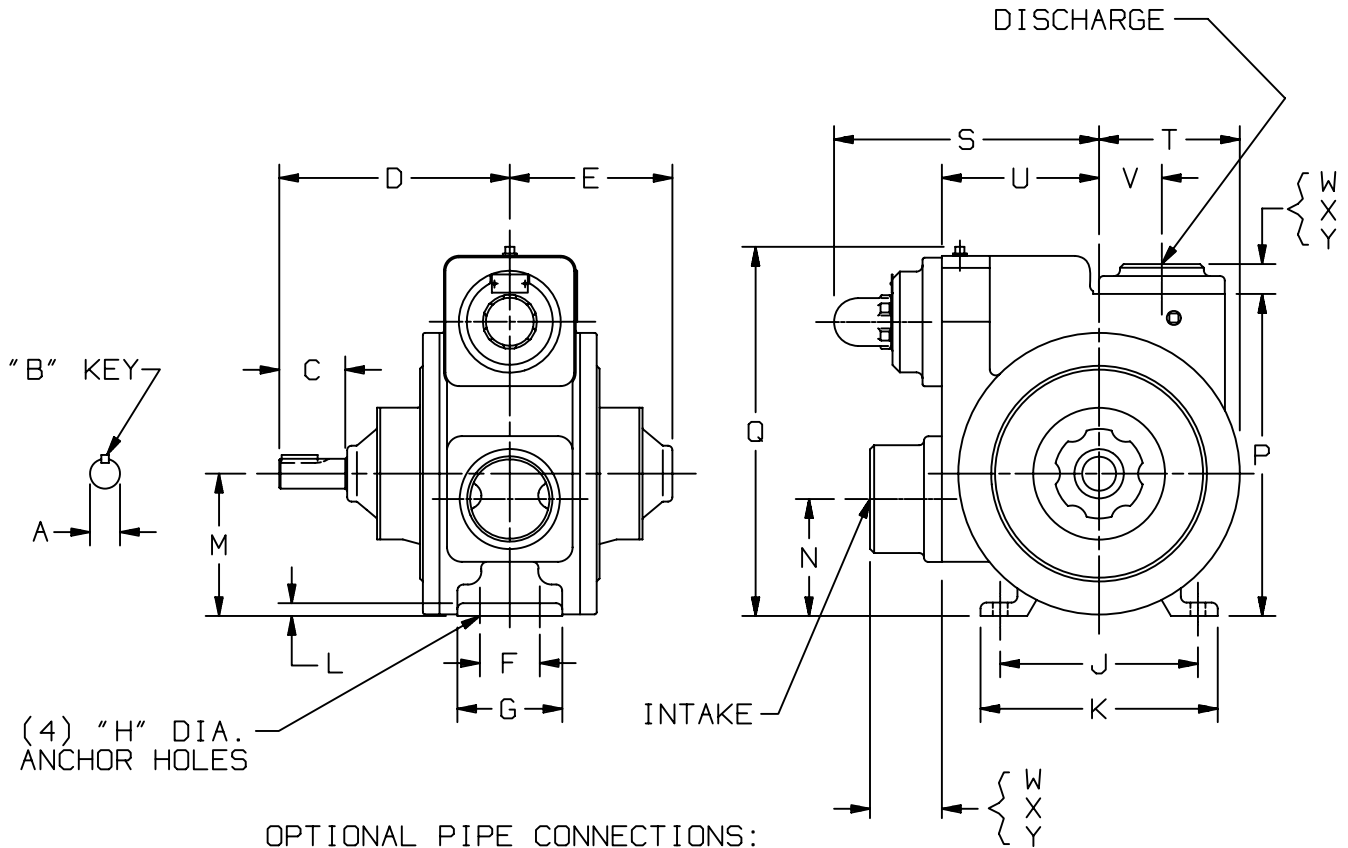

INTAKE

DISCHARGE

W=4" WELD FLG., STL.-STD.
X=3" WELD FLG., STL.-STD.
Y=3" NPT FLG., NODULAR

W=4" WELD FLG., STL.-STD.
X=3" WELD FLG., STL.-STD.
Y=3" NPT FLG., NODULAR

MOTOR			UNITS	DIMENSIONS									
FRAME SIZE				A	B	C	D	E	F	G	H	J	K
			IN	1 1/4	5/16	2 3/4	9 5/8	6 13/16	2 1/2	4 3/8	5/8	8 1/4	9 15/16
			MM	--	--	69,9	244,5	173	63,5	111,1	15,9	209,6	252,5
				L	M	N	P	Q	R	S	T	U	V
			IN	9/16	5 15/16	4 7/8	13 7/16	15 7/16	—	11 1/16	5 7/8	6 9/16	2 5/8
			MM	14,3	150,9	123,8	341,4	392,2	—	281,0	149,2	166,6	66,7
				W	X	Y	Z	AA	BB	CC	DD	EE	FF
			IN	3	1 1/4	1 1/2	—	—	—	—	—	—	—
			MM	76,2	31,8	38,1	—	—	—	—	—	—	—
				WEIGHT									
			LBS	205									
			KG	93									



TYPE	SIZE	UNIT STYLE
XLW	4	SK52W

DIMENSIONS 105-109	
Section Effective Replaces Page 2 / 7	105 SEPTEMBER 2023 NEW

RIGHT HAND ROTATION SHOWN.

*TOLERANCE $\pm 1/8$ "

TOLERANCE ON OTHER DIMENSIONS $\pm 1/4$ "

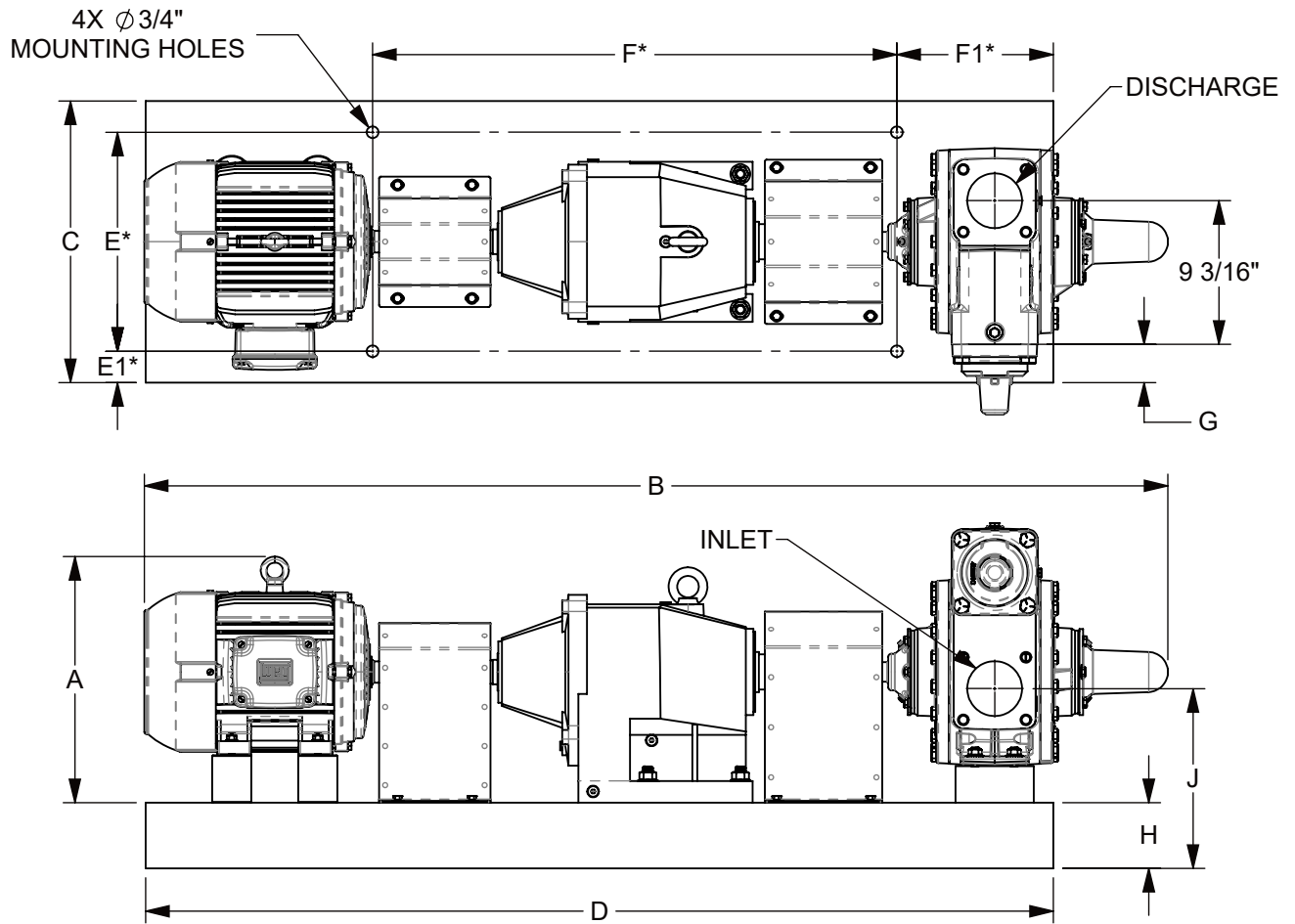

"A" DIMENSION LESS MOTOR EYEBOLT

MOTOR			BASE NO.	DIMENSIONS											APPROX. UNIT WT. - POUNDS	
FRAME SIZE	H.P.	RPM		A	B	C	D	E	E1	F	F1	G	H	J	LESS MOTOR	INCL. MOTOR
213T	7 1/2	1800	901461	15 3/4	65 3/8	18	58	14	2	33 1/2	10	2 1/2	4 1/4	11 1/2	848	1006
215T	10	1800	901461	15 3/4	66 7/8	18	58	14	2	33 1/2	10	2 1/2	4 1/4	11 1/2	848	1025
254T	15	1800	901463	16 5/8	70 3/4	18	64	14	2	32 1/2	12	2 1/2	4 1/4	11 1/2	876	1150
256T	20	1800	901463	16 5/8	72 1/2	18	64	14	2	32 1/2	12	2 1/2	4 1/4	11 1/2	876	1211
284T	25	1800	901464	17 1/2	73 5/8	18	64	15	1 1/2	30	14	2 1/2	4 1/4	11 1/2	877	1263
286T	30	1800	901464	17 1/2	75 1/8	18	64	15	1 1/2	30	14	2 1/2	4 1/4	11 1/2	877	1318

DIMENSIONS 105-109

Section Effective Replaces Page 3 / 7
 105 SEPTEMBER 2023
 APRIL 2014

TYPE

SIZE

UNIT STYLE

XLW

4A

PO



LEFT HAND ROTATION.

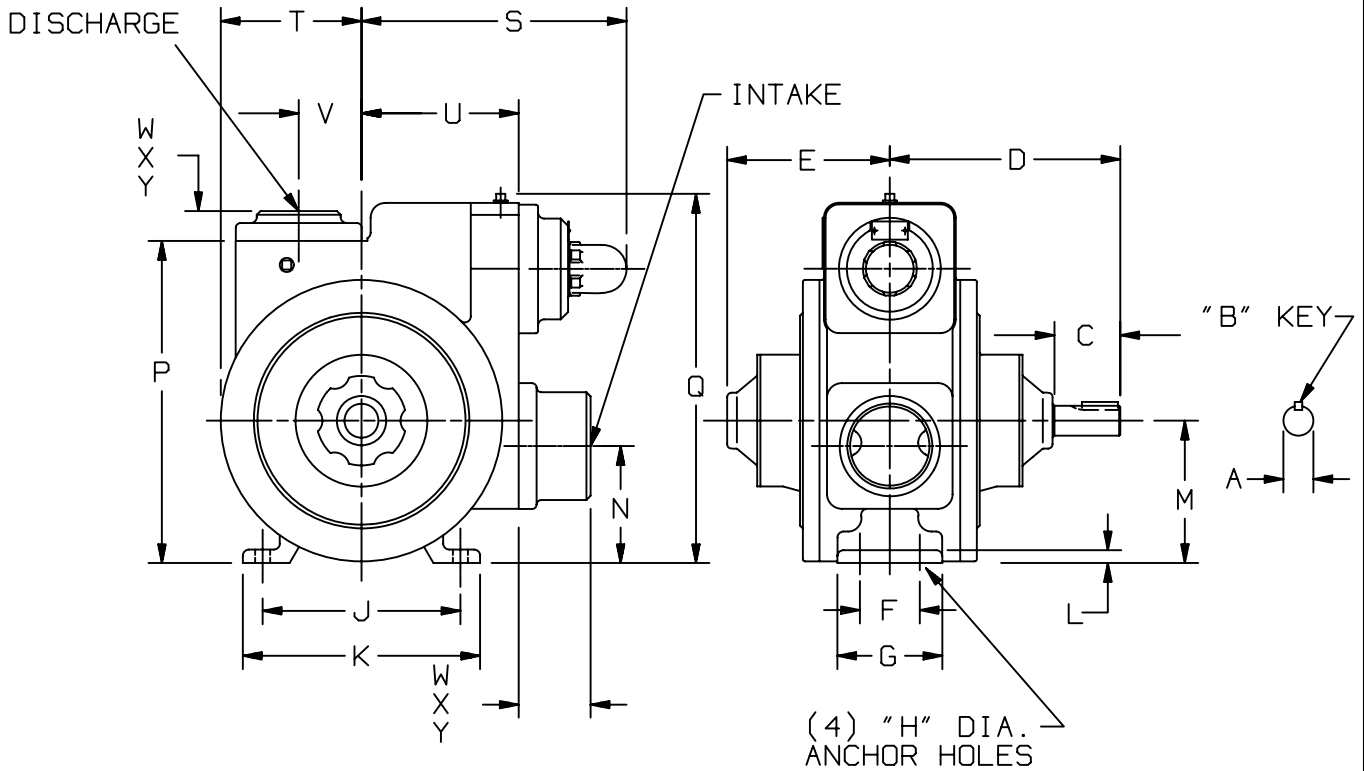

OPTIONAL PIPE CONNECTIONS:

INTAKE

DISCHARGE

W=4" WELD FLG., STL.-STD.
 X=3" WELD FLG., STL.-STD.
 Y=3" NPT FLG., NODULAR

W=4" WELD FLG., STL.-STD.
 X=3" WELD FLG., STL.-STD.
 Y=3" NPT FLG., NODULAR

MOTOR			UNITS	DIMENSIONS									
FRAME SIZE				A	B	C	D	E	F	G	H	J	K
			IN	1 1/4	5/16	2 3/4	9 5/8	6 13/16	2 1/2	4 3/8	5/8	8 1/4	9 15/16
			MM	--	--	69,9	244,5	173	63,5	111,1	15,9	209,6	252,5
				L	M	N	P	Q	R	S	T	U	V
			IN	9/16	5 15/16	4 7/8	13 7/16	15 7/16	—	11 1/16	5 7/8	6 9/16	2 5/8
			MM	14,3	150,9	123,8	341,4	392,2	—	281,0	149,2	166,6	66,7
				W	X	Y	Z	AA	BB	CC	DD	EE	FF
			IN	3	1 1/4	1 1/2	—	—	—	—	—	—	—
			MM	76,2	31,8	38,1	—	—	—	—	—	—	—
				WEIGHT									
			LBS	205									
			KG	93									

