

(See Instructions 1101-T00 for Installation, Operation and Maintenance)

Section	1101
Effective	October 2012
Replaces	New

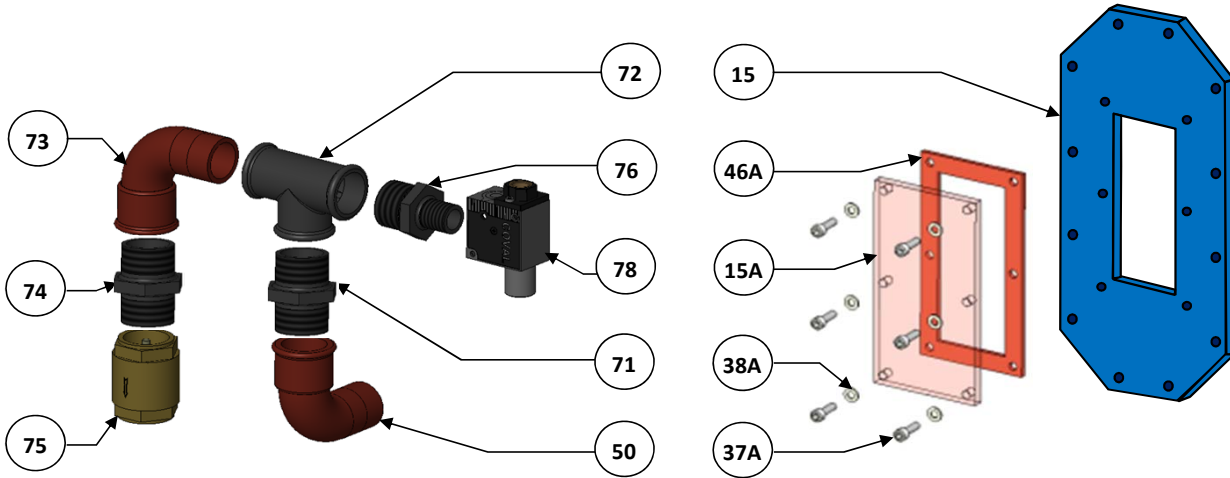

Elbow 50 : on the pump

Reference			Description	Qty order / (in pump)	Article code	Kit/Part
Ass.	Part	Available				
131		◆	<b>Ejector vacuum kit for A65 &amp; AS65 pumps</b>	<b>1</b>	<b>311901.00</b>	
	15	▲	Window adaptor	(1)	218644	
	15A	▲	Window	(1)	220208	
	37A		Screw	(6)		
	38A		Washer	(6)		
	46A		Window seal	(1)	217040	
	71		Nipple	(1)		
	72		T junction	(1)		
	73		Elbow	(1)		
	74		Nipple	(1)		
	75		Check valve	(1)		
	76		Nipple	(1)		
	78	▲	Ejector	(1)	217749	

(◆) Sets of parts or (▲) parts available to order.

■ Kit/Part for maintenance • Wear parts

Keep this parts lists with Installation, Operation and Maintenance Instructions.



Z.I. la Plaine des Isles - 2 rue des Caillottes F-89000 AUXERRE - FRANCE  
Tél : +33 (0)3 86 49 86 30 • Fax : +33 (0)3 86 49 87 17  
contact@mouvex.com • www.mouvex.com