

Neptune solenoid pump  
**NSP-A and NSP-P**  
Operating instructions



Read the operating manual!

The user is responsible for installation and operation related mistakes!



## Table of Contents

<b>1</b>	<b>Notes for the Reader</b> .....	<b>4</b>	<b>10</b>	<b>Control</b> .....	<b>25</b>
1.1	General non-discrimination .....	4	10.1	Operator controls of the control unit.....	25
1.2	Explanation of the signal words .....	4	10.2	Explanation of the menu icons.....	25
1.3	Explanation of the warning signs .....	4	<b>11</b>	<b>Operation</b> .....	<b>27</b>
1.4	Identification of warnings .....	4	11.1	Commissioning the dosing pump.....	27
1.5	Instruction for action identification .....	5	11.2	Operating modes .....	28
<b>2</b>	<b>Safety</b> .....	<b>6</b>	11.3	External On / Off via Release input.....	31
2.1	General warnings.....	6	11.4	Decommissioning the dosing pump.....	31
2.2	Hazards due to non-compliance with the safety instructions .....	7	11.5	Shutting down in an emergency .....	32
2.3	Working in a safety-conscious manner .....	7	11.6	Storage .....	32
2.4	Personal protective equipment .....	7	11.7	Transportation.....	32
2.5	Personnel qualification .....	7	11.8	Disposal of old equipment .....	32
<b>3</b>	<b>Intended use</b> .....	<b>9</b>	<b>12</b>	<b>Maintenance</b> .....	<b>33</b>
3.1	Notes on product warranty .....	9	12.1	Maintenance intervals.....	33
3.2	Intended purpose .....	9	12.2	Tighten up dosing head bolts.....	33
3.3	Device revision .....	9	12.3	Change the diaphragm.....	34
3.4	Principles .....	9	12.4	Clean suction and pressure valves.....	34
3.5	Prohibited dosing media.....	9	<b>13</b>	<b>Troubleshooting</b> .....	<b>35</b>
3.6	Foreseeable misuse .....	9	13.1	Dosing pump not delivering or output too low .....	35
<b>4</b>	<b>Product description</b> .....	<b>11</b>	13.2	Dosing pump does not prime.....	35
4.1	Properties.....	11	13.3	Delivery rate varies .....	36
4.2	Scope of delivery .....	11	13.4	No stroke movement observed.....	36
4.3	Structure of the dosing pump .....	11	13.5	Dosing pump delivery rate too high.....	36
4.4	Function description .....	12	13.6	Diaphragm is torn or tears too often.....	36
4.5	Rating plate .....	12	13.7	Loud noises on the dosing pump .....	37
<b>5</b>	<b>Technical data</b> .....	<b>13</b>	<b>14</b>	<b>Spare parts</b> .....	<b>38</b>
5.1	Delivery capacity data .....	13	14.1	Diaphragm spare parts kits .....	38
5.2	Operating conditions and limits .....	13	14.2	Dosing head spare parts kits including valves .....	38
5.3	Approved media temperature .....	13	<b>15</b>	<b>Delivery characteristic curves</b> .....	<b>39</b>
5.4	Electrical specifications .....	14	<b>16</b>	<b>Index</b> .....	<b>40</b>
5.5	Other data .....	14			
<b>6</b>	<b>Dimensions</b> .....	<b>15</b>			
6.1	NSP-A and NSP-P with dosing head made of PVC, PP or PVDF .....	15			
6.2	NSP with dosing head made of stainless steel (1.4571).....	15			
<b>7</b>	<b>Installing the Dosing Pump</b> .....	<b>16</b>			
7.1	Set up information .....	16			
7.2	Installation examples .....	16			
<b>8</b>	<b>Hydraulic installations</b> .....	<b>17</b>			
8.1	Design of the system.....	17			
8.2	System piping.....	17			
8.3	Aligning the dosing head .....	17			
8.4	Hydraulic connections.....	18			
8.5	Connecting a leakage drain .....	19			
8.6	Connecting the dosing head venting facility .....	20			
8.7	Hydraulic accessories .....	20			
<b>9</b>	<b>Electrical installation</b> .....	<b>22</b>			
9.1	Principles .....	22			
9.2	Description of connection sockets .....	23			

# 1 Notes for the Reader

These Operating instructions contain information and behaviour rules for safe and designated operation of the dosing pump NSP-A and NSP-P.

Observe the following principles:

- Read the entire operating manual prior to starting-up the device.
- Ensure that everyone who works with or on the dosing pump has read the operating instructions and follows them.
- Keep the operating instructions for the entire service life of the dosing pump.
- Pass on the operating instructions to any subsequent owner of the dosing pump.

## 1.1 General non-discrimination

In this operating manual, only the male gender is used where grammar allows gender allocation. The purpose of this is to make the text easy to read. Men and women are always referred to equally. We would like to ask female readers for understanding of this text simplification.

## 1.2 Explanation of the signal words

Different signal words in combination with warning signs are used in this operating manual. Signal words illustrate the gravity of possible injuries if the risk is ignored:

Signal word	Meaning
DANGER	Refers to imminent danger. Ignoring this sign may lead to death or the most serious injuries.
WARNING	Refers to a potentially hazardous situation. Failure to follow this instruction may lead to death or severe injuries.
CAUTION	Refers to a potentially hazardous situation. Failure to follow this instruction may lead to minor injury or damage to property.
NOTE	Refers to a danger which, if ignored, may lead to risk to the machine and its function.

Table 1: Explanation of the signal words

## 1.3 Explanation of the warning signs

Warning signs represent the type and source of a danger:







Warning sign	Type of danger
	Danger point
	Danger from electrical voltage
	Danger from corrosive substances
	Danger from potentially-explosive substances
	Danger from automatic startup
	Danger from electromagnetic radiation
	Danger of damage to machine or functional influences

Table 2: Explanation of the warning signs

## 1.4 Identification of warnings

Warnings are intended to help you recognise risks and avoid negative consequences.

This is how warnings are identified:

Warning sign	SIGNAL WORD
<p><b>Description of danger.</b>                      Consequences if ignored.                      ⇨ The arrow signals a safety precaution to be taken to eliminate the danger.</p>	

## 1.5 Instruction for action identification

This is how pre-conditions for action are identified:

- ✓ Pre-condition for action which must be met before taking action.
- ✘ A resource such as a tool or auxiliary materials required to perform the operating instructions.

This is how instructions for action are identified:

- ➔ Separate step with no follow-up action.
- 1. First step in a series of steps.
- 2. Second step in a series of steps.
  - ▶ Result of the above action.
- ✓ **Action completed, aim achieved.**

## 2 Safety

### 2.1 General warnings

The following warnings are intended to help you to eliminate the dangers that can arise while handling the dosing pump. Risk prevention measures always apply regardless of any specific action.

Safety instructions warning against risks arising from specific activities or situations can be found in the respective sub-chapters.

	<b>DANGER</b>
<p><b>Mortal danger from electric shock!</b></p> <p>Wrongly connected or located cables or damaged ones can injure you.</p> <ul style="list-style-type: none"> <li>⇒ Connect the device only to a SCHUKO socket outlet protected by a ground fault circuit interrupter (GFCI).</li> <li>⇒ Replace damaged cables without delay.</li> <li>⇒ Do not use extension cables.</li> <li>⇒ Do not bury cables.</li> <li>⇒ Secure cables to avoid being damaged by other equipment.</li> </ul>	

	<b>DANGER</b>
<p><b>Danger to life through explosions!</b></p> <p>The use of dosing pumps without ATEX certification in a potentially explosive atmospheres can result in potentially-fatal explosions.</p> <ul style="list-style-type: none"> <li>⇒ Never use the dosing pump in potentially explosive areas.</li> </ul>	

	<b>WARNING</b>
<p><b>Danger from unsuitable materials</b></p> <p>The materials of the dosing pump and hydraulic parts of the system must be suitable for the dosing medium that is used. Should this not be the case, the dosing media may leak.</p> <ul style="list-style-type: none"> <li>⇒ Make sure that the materials you are using are suitable for the dosing medium.</li> <li>⇒ Make sure that the lubricants, adhesives, sealants, etc. that you use are suitable for the dosing medium.</li> </ul>	

	<b>WARNING</b>
<p><b>Caustic burns or other burns through dosing media!</b></p> <p>While working on the dosing head, valves and connections, you may come into contact with dosing media.</p> <ul style="list-style-type: none"> <li>⇒ Use sufficient personal protective equipment.</li> <li>⇒ Rinse the dosing pump with a liquid (e.g. water) which does not pose any risk. Ensure that the liquid is compatible with the dosing medium.</li> <li>⇒ Release pressure in hydraulic parts.</li> <li>⇒ Never look into open ends of plugged pipelines and valves.</li> </ul>	

	<b>WARNING</b>
<p><b>Danger of automatic start up!</b></p> <p>After connecting the mains supply, residual dosing media in the dosing head can spray out.</p> <ul style="list-style-type: none"> <li>⇒ Before connecting the mains supply, connect the dosing lines.</li> <li>⇒ Check that all the screw connections have been tightened correctly and are leak-proof.</li> </ul>	

	<b>WARNING</b>
<p><b>Danger from electromagnetic radiation!</b></p> <p>Solenoid diaphragm dosing pumps In operation, solenoid diaphragm dosing pumps emit a stray magnetic field. If you do not keep far enough away, the function of a pacemaker can be negatively affected.</p> <ul style="list-style-type: none"> <li>⇒ People with pacemakers must always keep at least 1.9 inch away from the dosing pump.</li> </ul>	

	<b>CAUTION</b>
<p><b>Danger when changing the dosing medium!</b></p> <p>Changing the dosing media can provoke unexpected reactions, damage to property and injury.</p> <ul style="list-style-type: none"> <li>⇒ Clean the dosing pump and the system parts in contact with the media thoroughly before changing the dosing medium.</li> </ul>	

	<b>CAUTION</b>
<p><b>Increased risk of accidents due to insufficient qualification of personnel!</b></p> <p>Dosing pumps and their accessories may only be installed, operated and maintained by personnel with sufficient qualifications. Insufficient qualification will increase the risk of accidents.</p> <p>⇒ Ensure that all action is taken only by personnel with sufficient and corresponding qualifications.</p> <p>⇒ Prevent access to the system for unauthorised persons.</p>	

## 2.2 Hazards due to non-compliance with the safety instructions

Failure to follow the safety instructions may endanger not only persons, but also the environment and the device.

The specific consequences can be:

- Failure of vital functions of the dosing pump and the system
- Failure of required maintenance and repair methods
- Danger for individuals through dangerous dosing media
- Danger to the environment caused by substances leaking from the system

## 2.3 Working in a safety-conscious manner

Besides the safety instructions specified in this operating manual, further safety rules apply and must be followed:

- Accident prevention regulations
- Safety and operating provisions
- Safety provisions for handling dangerous substances (mostly the safety data sheets to dosing media)
- Environmental protection provisions
- Applicable standards and legislation

## 2.4 Personal protective equipment

Based on the degree of risk posed by the dosing medium and the type of work you are carrying out, you must use corresponding protective equipment. Read the Accident Prevention Regulations and the Safety Data Sheets to the dosing media find out what protective equipment you need.

You will require the minimum of the following personal protective equipment:



Personal protective equipment required	
	Protective goggles
	Protective clothing
	Protective gloves

Table 3: Personal protective equipment required

Wear the following personal protective equipment when performing the following tasks:

- Commissioning
- Working on the dosing pump while running
- Shutdown
- Maintenance work
- Disposal

## 2.5 Personnel qualification

Any personnel who work on the dosing pump must have appropriate special knowledge and skills.

Anybody who works on the dosing pump must meet the conditions below:

- Attendance at all the training courses offered by the owner,
- personal suitability for the respective activity,
- sufficient qualification for the respective activity,
- Training in handling of the dosing pump,
- knowledge of safety equipment and the way this equipment functions,
- knowledge of this operating manual, particularly of safety instructions and sections relevant for the activity,
- knowledge of fundamental regulations regarding health and safety and accident prevention.

All persons must generally have the following minimum qualification:

- Training as specialists to carry out work on the dosing pump unsupervised,
- sufficient training that they can work on the dosing pump under the supervision and guidance of a trained specialist.

These operating instructions differentiate between these user groups:

### 2.5.1 Specialist staff

Thanks to their professional training, knowledge, experience and knowledge of the relevant specifications, specialist staff are able to perform the job allocated to them and recognise and/or eliminate any possible dangers by themselves.

### 2.5.2 Trained persons

Trained persons have received training from the operator about the tasks they are to perform and about the dangers stemming from improper behaviour.

In the table below you can check what qualifications are the pre-condition for the respective tasks. Only people with appropriate qualifications are allowed to perform these tasks!

Qualification	Activities
Specialist staff	<ul style="list-style-type: none"><li>■ Assembly</li><li>■ Hydraulic installations</li><li>■ Electrical installation</li><li>■ Maintenance</li><li>■ Repairs</li><li>■ Commissioning</li><li>■ Taking out of operation</li><li>■ Disposal</li><li>■ Fault rectification</li></ul>
Trained persons	<ul style="list-style-type: none"><li>■ Storage</li><li>■ Transportation</li><li>■ Control</li><li>■ Fault rectification</li></ul>

Table 4: Personnel qualification



### 3 Intended use

#### 3.1 Notes on product warranty

Any non-designated use of the product can compromise its function or intended protection. This leads to invalidation of any warranty claims!

Please note that liability is on the side of the user in the following cases:

- The dosing pump is operated in a manner which is not consistent with these operating instructions, particularly safety instructions, handling instructions and the section "Intended Use".
- If people operate the product who are not adequately qualified to carry out their respective activities.
- No original spare parts or accessories of Neptune are used.
- Unauthorised changes are made to the device by the user.
- The user uses different dosing media than those indicated in the order.
- The user does not use dosing media under the conditions agreed with the manufacturer such as modified concentration, density, temperature, contamination, etc.

#### 3.2 Intended purpose

The dosing pump NSP-A and NSP-P is intended for the following purpose: the conveying and dosing of liquids.

#### 3.3 Device revision

This operating manual applies to the following devices:

Device	Month / year of manufacture	Firmware
NSP-A	11/2016 onwards	From 01:59
NSP-P	11/2016 onwards	From 01:59

Table 5: Device revision

#### 3.4 Principles

- Before delivery, the manufacturer inspected the dosing pump and operated it under specific conditions (with a specific dosing medium with a specific density and temperature, with specific pipe dimensions, etc.) Since these conditions differ at every location of usage, the delivery capacity of the dosing pump should be measured by gauging it at the operating company's installation. For details on the approximate values and the capacity of the dosing pump, refer to the chapter 15 "Delivery characteristic curves" on page 39.
- Comply with the information regarding the operating and environmental conditions (see chapter "Technical data").
- Any restrictions regarding the viscosity, temperature and density of dosing media must be followed. You must only use dosing media at temperatures above freezing point or below the boiling point of the respective medium.

- The materials of the dosing pump and hydraulic parts of the system must be suitable for the dosing medium that is used. In this connection, note that the resistance of these components can change in dependence on the temperature of the media and the operating pressure.



Information on the suitability of materials combined with different dosing media can be found in the Compatibility Chart of Neptune.

The information in this resistance list is based on information from the material manufacturers and on expertise obtained by Neptune from handling the materials.

As the durability of the materials depends on many factors, this list only constitutes initial guidance on selecting material. In all cases, test the equipment with the chemicals you use under operating conditions.

- The dosing pump is not intended for outdoor use unless appropriate protective measures have been taken.
- Avoid leaks of liquids and dust into the casing and avoid direct exposure to sunlight.
- You must never operate dosing pumps in a potentially explosive atmosphere if they do not have corresponding nameplates or an appropriate EC Declaration of Conformity for potentially explosive atmospheres.

#### 3.5 Prohibited dosing media

The dosing pump must not be used for these media and substances:

- Gaseous media,
- radioactive media,
- solid substances,
- combustible media,
- all other media that are not suitable for delivery using this dosing pump.

#### 3.6 Foreseeable misuse

Below, there is information about the applications of the dosing pump or associated equipment that are not considered to be intended use. This section is intended to allow you to detect possible misuse in advance and to avoid it.

Foreseeable misuse is assigned to the individual stages of the product lifetime:

### 3.6.1 Incorrect assembly

- Unstable or unsuitable bracket
- Dosing pump bolted wrongly or loosely

### 3.6.2 Incorrect hydraulic installation

- Suction and pressure lines dimensioned incorrectly
- Unsuitable connection of the pipes due to wrong material or unsuitable connections.
- Suction and pressure lines mixed-up
- Damage to threads due to them being tightened too much
- Bending of pipelines
- No free return flow of the pressure relief valve
- Excessive demand due to the pressure differences between the suction and pressure valves
- Through-suction at installation without back-pressure valves
- Damage due to undamped acceleration mass forces
- Exceeding the admissible pressure on the suction and discharge sides
- Using damaged parts

### 3.6.3 Incorrect electrical installation

- Connecting the mains voltage without a protective earth
- Unsecured mains or one that does not conform to standards
- Not possible to immediately or easily disconnect the power supply
- Wrong connecting cables for mains voltage
- Dosing pump accessories connected to wrong sockets
- Diaphragm monitoring not connected or defective
- Protective earth removed

### 3.6.4 Incorrect start-up

- Start-up with damaged system
- Shut-off valves closed at commissioning
- Closed suction or pressure line, e.g. due to blockages
- Personnel was not informed before the start-up
- System was recommissioned after maintenance without all the protective equipment and fixtures, etc. being reconnected.
- Inadequate protective clothing or none at all

### 3.6.5 Incorrect operation

- Protective equipment not functioning correctly or dismantled
- Modification of the dosing pump without authority
- Ignoring operational disturbances
- Elimination of operational disturbances by personnel without adequate qualifications
- Deposits in the dosing head due to inadequate purging, particularly with suspensions
- Bridging the external fuse
- Operation made more difficult due to inadequate lighting or machines that are difficult to access
- Operation not possible due to dirty or illegible display of the dosing pump

- Delivery of dosing media for which the system is not designed
- Delivery of particulate or contaminated dosing media
- Inadequate protective clothing or none at all

### 3.6.6 Incorrect maintenance

- Carrying out maintenance during ongoing operation
- Carrying out work that is not described in the operating manual
- No adequate or regular inspection of correct functioning
- No replacement of damaged parts or cables with inadequate insulation
- No securing against reactivation during maintenance work
- Using cleaning materials that can cause reactions with the dosing media
- Inadequate cleaning of the system
- Unsuitable purging medium
- Unsuitable cleaning materials
- Detergents left in system parts
- Using unsuitable cleaning equipment
- Using the wrong spares or lubricants
- Contaminating the dosing medium with lubricant
- Installing spare parts without following the instructions in the operating manual
- Blocking venting orifices
- Pulling off sections of the plant
- Contamination at installation without a dirt trap
- Mixing up the valves
- Mixing up the sensor lines
- Not reconnecting all the lines
- Damaging or not installing all the seals
- Not renewing seals
- Not paying attention to safety data sheets
- Inadequate protective clothing or none at all

### 3.6.7 Incorrect decommissioning

- Not completely removing the dosing medium
- Dismantling lines while the dosing pump is running
- Device not disconnected from the power supply
- Using the wrong dismantling tools
- Inadequate protective clothing or none at all

### 3.6.8 Incorrect disposal

- Incorrect disposal of dosing media, operating resources and other materials
- No labelling of hazardous substances

## 4 Product description

### 4.1 Properties

The NSP is a solenoid diaphragm dosing pump that is used when precise dosing results are required.

They are characterized by the following properties:

- Output range from 0.09 to 3.43 gph, up to 232 psig.
- Reproducible dosing precision of  $\pm 2\%$ .
- Integrated automatic dosing head venting facility (except with stainless steel dosing heads (1.4571)).
- Suitable for highly aggressive or poisonous dosing media.
- Operating modes: Manual mode, pulse input, analogue input (only LA).
- Graphic display: 128 x 64 px, 1.5", monochrome, illuminated.
- Menu languages: English, German, French, Spanish, Portuguese, Dutch, Polish.
- Four multifunction keys for operator inputs.
- Floor- and wall-mounting options.
- Connections: M12x1 plug, A-coded.

### 4.2 Scope of delivery

Please compare the delivery note with the scope of delivery. The following items are part of the scope of delivery:

- Dosing pump NSP-A and NSP-P.
- One set each of hose clamping connections for the suction and discharge sides for hoses with diameters of 4/6 mm, and 1/4 x 3/8" (made of PVC, PP and PVDF).
- Covering caps electrical connections.
- 2 conductive rubber bands for electrical contacts (installed in connection sockets 1 and 3).
- Cable with M12x1 plug connector, A-coded, 2 m long, open cable end 4-pin.
- Mains cable.
- Operating instructions.
- Inspection report and test certificate (optional).
- Accessory kit (optional).

### 4.3 Structure of the dosing pump

#### 4.3.1 General Overview

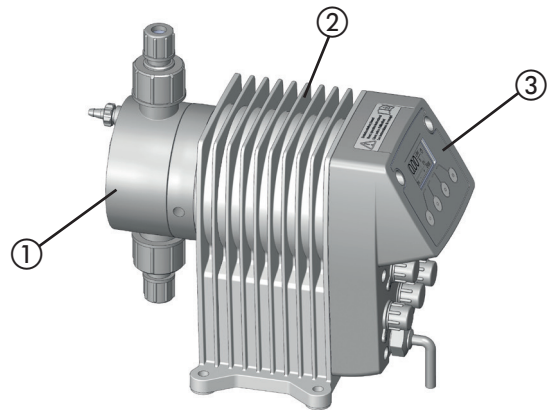

Fig. 1: Dosing pump overview NSP-A and NSP-P

No.	Description
1	Dosing head
2	Drive unit
3	Control box

Table 6: General Overview

#### 4.3.2 Dosing head

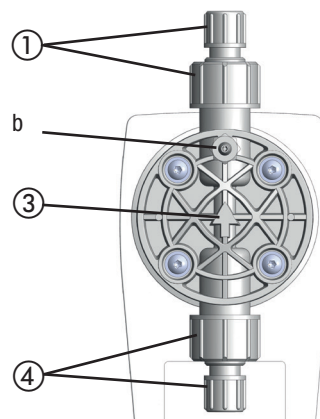

Fig. 2: Dosing head

No.	Description
1	Valve and connection on the discharge side
2	Integrated dosing head ventilation
3	Arrow indicating the direction of throughflow of the dosing medium
4	Valve and connection on the suction side

Table 7: Dosing head

### 4.3.3 Control elements

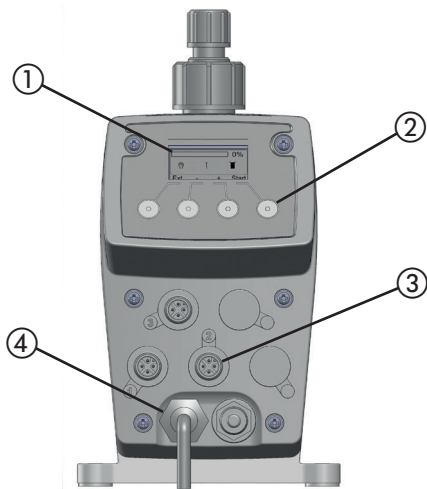

Fig. 3: Controller of dosing pump NSP-A and NSP-P

No.	Description
1	Graphic display
2	Multifunction keys on the control unit for operator inputs
3	Connection ports for external operation
4	Mains cable for power supply

Table 8: Designation of components

### 4.4 Function description

Dosing pumps are positive displacement pumps. They are used if precisely defined delivery of a medium is necessary. A constant volume per stroke or time is delivered.

The system delivers or meters the dosing medium by means of a repeated sequence of suction strokes followed by pressure strokes. This results in a pulsing flow.

If the dosing pump is in the suction stroke phase, the diaphragm is pulled into the rear final position. Due to the resulting vacuum in the dosing head, the pressure valve closes, the suction valve opens and dosing medium flows from the suction line into the dosing head.

If the dosing pump is in the pressure stroke phase, the diaphragm is moved into the front final position. Due to the pressure in the dosing head, the suction valve closes and the dosing medium flows through the pressure valve from the dosing head into the pressurised pipe.

### 4.5 Rating plate

There is information on the equipment about safety or the product's way of functioning. The information must stay legible for the duration of the service life of the product.

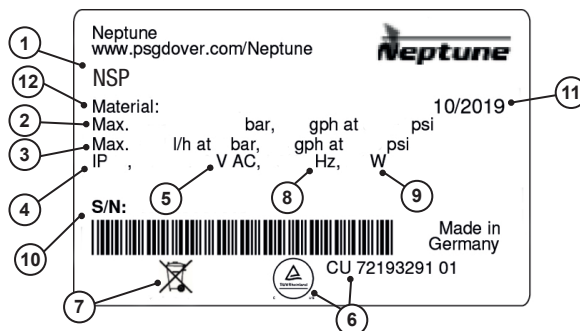

Fig. 4: Rating plate NSP-A and NSP-P

No.	Description
1	Product, type, nominal size
2	Maximum delivery capacity at average pressure
3	Maximum delivery capacity at maximum pressure
4	Protection class
5	Voltage supply
6	CSA certificate
7	WEEE label
8	Frequency
9	Power consumption
10	Serial number
11	Month / year of manufacture
12	Material of the dosing head / seals

Table 9: Rating plate

## 5 Technical data

### 5.1 Delivery capacity data

Please note that some of this data only represents guide values. The actual capacity of a dosing pump depends on various factors. For approximate values of the delivery capacity at different pressures, refer to chapter 15 "Delivery characteristic curves" on page 39.

Information	Unit	NSP-A and NSP-P Size						
		A09 / P09	A20 / P20	A50 / P50	A89 / P89	A164 / P164	A240 / P240	A343 / P343
Delivery capacity at max. backpressure	gph	0.09	0.20	0.50	0.89	1.64	2.40	3.34
	ml/stroke	0.05	0.05	0.2	0.32	0.57	0.83	0.87
Max. delivery pressure	psig	232				116	87	43
Delivery capacity at average backpressure	gph	0.14	0.29	0.61	1.00	1.80	2.64	4.00
	ml/stroke	0.08	0.08	0.24	0.35	0.63	0.92	1
Average delivery pressure	psig	116				58	43	14
Max. stroke frequency	rpm	120	250	160	180			250

Table 10: Output data

### 5.2 Operating conditions and limits

Information	Unit	NSP-A and NSP-P Size
Approved ambient temperature	°F	41 – 113 (with PVC components 41 – 104)*
Relative humidity	%	max. 90
Max. sound pressure level (depressurised)	dB(A)	68 – 75
Max. sound pressure level (at test pressure)	dB(A)	65 – 70
Max. supply pressure	psig	11
Viscosity limits	mPa·s	300** / 1000***
Adjustable dosing range	%	0 – 100

Table 11: Operating conditions and limits

\* Use of the dosing pump at ambient temperatures below 41 °F must be checked individually. In such cases, please contact the manufacturer.

\*\* With a viscosity of ~300 mPa·s and above, you must use spring-loaded valves.

\*\*\* If the viscosity is above 1000 mPa·s, this must be checked individually and the stroke frequency must be between 50 and 100 strokes/min.

### 5.3 Approved media temperature

Information	Unit	NSP-A and NSP-P (all sizes)
Dosing head made of PVC	°F	32 – 95
Dosing head made of PP	°F	32 – 140

Table 12: Approved media temperature

Information	Unit	NSP-A and NSP-P (all sizes)
Dosing head made of PVDF	°F	32 – 140
Dosing head made of stainless steel (1.4571)	°F	32 – 176

Table 12: Approved media temperature

## 5.4 Electrical specifications

Information	Value	NSP-A and NSP-P Size						
		A09 / P09	A20 / P20	A50 / P50	A89 / P89	A164 / P164	A240 / P240	A343 / P343
Voltage supply		230 V AC $\pm$ 10 %, 50/60 Hz or 115 V AC $\pm$ 10 %, 50/60 Hz (see rating plate)						
Power consumption	W	8	13	19	25	25	25	22
Max. current consumption during dosing stroke	A	2.0		3.0	3.7	3.8	4.1	3.6

Table 13: Electrical specifications

## 5.5 Other data

Information	Value	NSP-A and NSP-P Size						
		A09 / P09	A20 / P20	A50 / P50	A89 / P89	A164 / P164	A240 / P240	A343 / P343
Weight (dosing head made of PVC, PP, PVDF)	lb	7.1 approx.						
Weight (dosing head made of stainless steel (1.4571))	lb	9.5 approx.						
Diameter of diaphragm	in	0.9		1.3		1.5		
Electrical cable	ft	5.9 ft (with mains plug)						
Protection class		IP65 (with covering caps on the connections)						
Insulation class		F						
Valve connection		G 5/8 male						
Valve size		DN3			DN4			

Table 14: Other data

## 6 Dimensions

### 6.1 NSP-A and NSP-P with dosing head made of PVC, PP or PVDF

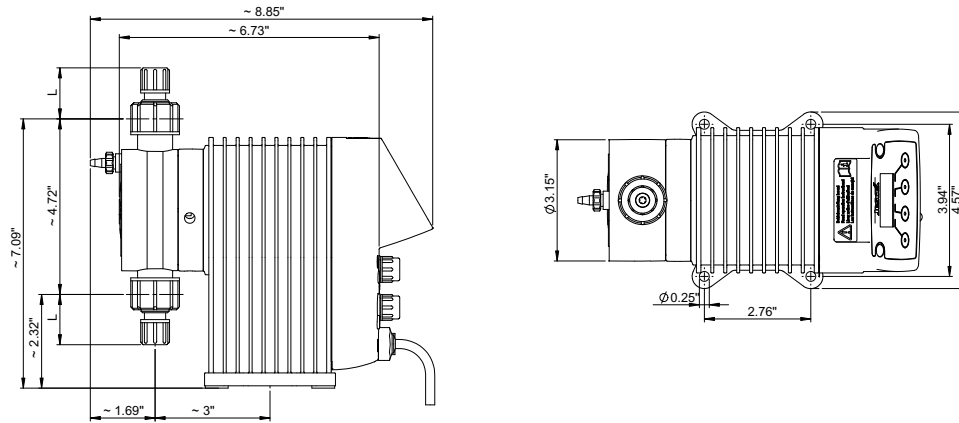

Fig. 5: Dimensioned drawing of NSP-A and NSP-P with dosing head made of PVC, PP or PVDF (all dimensions in inch)

Connection	Material	Scale	Nominal width	L
Hose clamp connector	PVC / PP / PVDF	4/6 mm	DN4	31
		1/4" x 3/8"	1/4"	13

### 6.2 NSP with dosing head made of stainless steel (1.4571)

Original OIM calls out for 204mm and 168mm for the stainless-steel head.

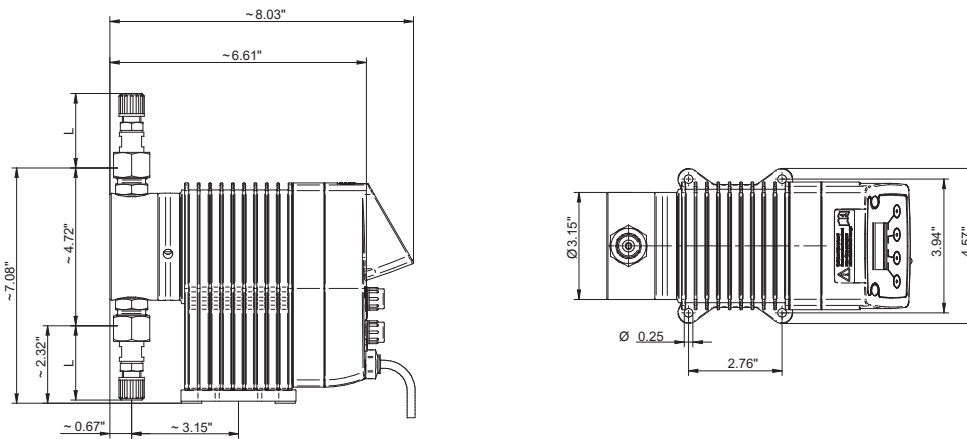

Fig. 6: Dimensioned drawing of NSP-A and NSP-P with dosing head made of stainless steel 1.4571 (all dimensions in inch)

Connection	Material	Scale	Nominal width	L
Hose clamp connector	Stainless steel (1.4571) / PVDF	4/6 mm	DN4	50



## 7 Installing the Dosing Pump



### DANGER

#### Mortal danger from electric shock!

Electrically conductive liquid can enter pump housings, cable screw connections and mains connectors.

- ⇒ Make sure that all protective measures comply at least with the requirements of protection class IP65.
- ⇒ Always set up the dosing pump such that water cannot enter the housing.



### CAUTION

#### Danger of personal injury and material damage!

A dosing pump that is difficult to access represents a danger due to incorrect operation and faulty maintenance.

- ⇒ Install the dosing pump such that it is accessible at all times.

### 7.1 Set up information

When installing, follow the basic principles below:

- The valves must be vertical: Pressure valve at top, suction valve at bottom. In this connection, pay attention to the arrow on the dosing head. The dosing head must be aligned such that the arrow points vertically upwards.
- You should install the dosing pump at a convenient height for operation.
- It must not be installed under the ceiling.
- The frame of foundation for fixing the dosing pump must not be subjected to jolts. The pump must be vibration-free and stable.
- There must be enough free space in the area of the dosing head and the suction and pressure valves for these parts to be easily dismantled if required. The entire space requirement for installation and maintenance is approximately 1 m<sup>2</sup>.
- The distance from the sides of the dosing pump to the wall or other dosing pumps or equipment must be at least 1.18 inch. There must be a guaranteed flow of circulating air.
- The maximum ambient temperature must be complied with, see chapter 5.2 "Operating conditions and limits" on page 13. If necessary, radiant heat from surrounding equipment must be screened.
- Avoid exposure to direct sunlight.
- The dosing pump is not intended for use out of doors unless appropriate protective measures have been taken to prevent dust and water from entering the housing.
- For the dimensions of the fastening holes, refer to chapter 6 "Dimensions" on page 15.
- The tightening torque for the fastening bolts is 1.5 – 2 Nm.

### 7.2 Installation examples

#### 7.2.1 Installation on a wall console

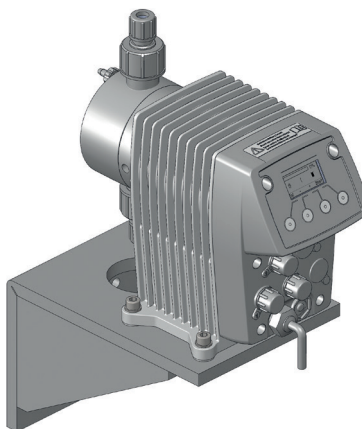

Fig. 7: Installation on a wall console

To reduce the structure-borne noise, the dosing pump is bolted to the wall bracket using rubber elements. The materials necessary for this are included with the wall bracket.

#### 7.2.2 Installation on the wall

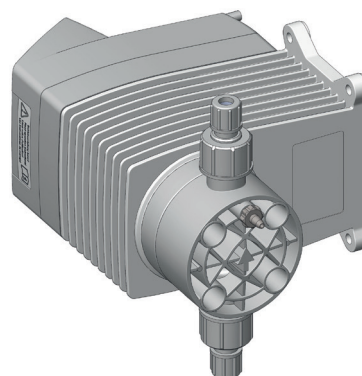



Fig. 8: Installation on the wall

The dosing pump can be mounted to the floor or directly to the wall without the need for additional elements. Turn the dosing head appropriately to ensure the flow direction of the medium through the dosing head.





## 8 Hydraulic installations

In this chapter, you will find information about the hydraulic parts of a system that you should install or that can install additionally. In many cases, you must install hydraulic accessories to be able to use all the functions that the dosing pump offers, to guarantee functional safety or to achieve a high level of dosing precision.

	<b>WARNING</b>
<p><b>Caustic burns or other burns through dosing media!</b></p> <p>A diaphragm rupture, blocked pressure lines or the use of material not suitable for the dosing medium can result in the discharge of dosing medium. Depending on the type and hazardousness of the dosing medium, this can result in injury.</p> <ul style="list-style-type: none"> <li>⇒ Wear the recommended personal protective equipment.</li> <li>⇒ Make sure that the materials you are using are suitable for the dosing medium.</li> <li>⇒ Make sure that the lubricants, adhesives, sealants, etc. that you use are suitable for the dosing medium.</li> <li>⇒ Install a leakage drain.</li> <li>⇒ Install pressure relief valves.</li> </ul>	

	<b>CAUTION</b>
<p><b>Danger of personal injury and material damage!</b></p> <p>High peak pressures can lead to piping vibrating and cause them to snap. This can result in injury from piping or escaping dosing media.</p> <ul style="list-style-type: none"> <li>⇒ Install pulsation dampeners.</li> </ul>	

	<b>NOTE</b>
<p><b>Damage to drives due to overloading</b></p> <p>The pressure conditions between the suction and discharge sides must be balanced; otherwise, overloading can result. This can lead to uncontrolled dosing processes, damage to the piping and to the dosing pump.</p> <ul style="list-style-type: none"> <li>⇒ Ensure that the pressure on the discharge side is at least 14.5 psig than on the suction side.</li> </ul>	

	<b>NOTE</b>
<p><b>Locking of threads</b></p> <p>Stainless steel and plastic parts (particularly those made of PVC) that are bolted together in a detachable connection (e.g. the dosing head and the valves) can lock. This makes them difficult to release.</p> <ul style="list-style-type: none"> <li>⇒ Before bolting, grease the corresponding parts with a lubricant (e.g. PTFE spray). Ensure that the lubricant is compatible with the dosing medium.</li> </ul>	

### 8.1 Design of the system

- The dosing pump's technical data must be taken into account and the plant's layout must be set up appropriately (e.g. pressure loss when rating the lines with regard to their nominal diameter and length).
- The entire system and its integrated dosing pump must be designed in such a way that an escaping dosing medium (due to the failure of wearing parts such as the diaphragm, or burst hoses) does not lead to permanent damage to system parts or the premises.
- The leakage opening of the dosing head must be visible so that you can detect a diaphragm rupture. It must be possible for the outflow from the leakage drain to be on a free downwards gradient.
- If you use hazardous dosing media, the installation must be designed such that no disproportionately high consequential damages arise due to dosing media escaping.
- To avoid dosing errors after the end of the process, the dosing pump must be locked hydraulically.
- To allow you to easily inspect the pressure conditions in the system, you should provide connections for pressure gauges close to the suction and pressure valves.

### 8.2 System piping

- The system piping must not exert any force on the connections and valves of the dosing pump.
- This means that steel piping should be connected to the dosing pump by means of flexible pipe sections.
- The nominal diameters of the pipework and the installed fittings should be rated the same as or greater than the nominal diameters of the dosing pump's suction and pressure valves.
- The suction line should be kept as short as possible.
- You should avoid intertwined hoses.
- Avoid loops, since air bubbles can collect.

### 8.3 Aligning the dosing head

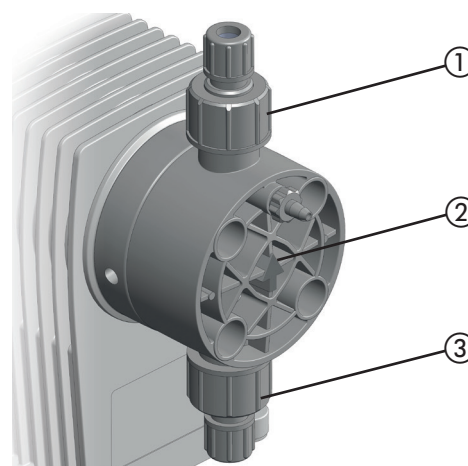

Fig. 9: Aligning the dosing head

When connecting the dosing lines to the dosing pump, you must observe the direction of through-flow (see arrow 2). The dosing head must be aligned vertically. The alignment can be changed in 90° intervals.

The suction valve (3) must always point downwards. Accordingly, arrow (2) and pressure valve (1) always point upwards. This is irrespective of the positioning of the dosing head to the drive.

## 8.4 Hydraulic connections

### 8.4.1 Connecting hose clips

Choose the hose connection according to the condition of the hose (material, inner diameter, wall thickness) in order to ensure maximum pressure resistance.

#### 8.4.1.1 Size 4/6

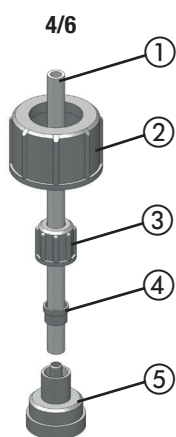

Fig. 10: Hose clips 4/6 (internal and external diameters in mm)

Perform the following working steps:

1. Cut the hose (1) to the appropriate length neatly and at an exact right angle.
2. Place a gasket that is suitable for the dosing medium between the connection (5) and the valve.
3. Screw the connecting piece to the dosing pump's valve.
4. Thread the union nut (3) and the clamping ring (4) onto the hose.
5. Plug the hose all the way in to the grommet of connection piece.
6. Push the clamping ring onto the grommet of connection piece and screw it to the union nut.
7. Carry out the same procedure with the connection to the dosing pump's other valve.

✓ **Hose clip connected.**

#### 8.4.1.2 Size 6/12

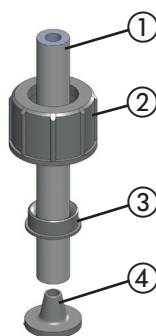

Fig. 11: Hose clip 6/12 (internal and external diameter in mm)

Size 6/12 hose clips only have a union nut. It clamps the hose onto the grommet of the connection piece and at the same time fastens on the dosing pump's valve.

Perform the following working steps:

1. Cut the hose (1) to the appropriate length neatly and at an exact right angle.
2. Place a gasket that is suitable for the dosing medium between the connection (4) and the valve.
3. Push the union nut (2) and the cutting ring (3) over the hose.
4. Press the end of the hose onto the grommet of connection piece. You can do this more easily by moistening the end of the hose on the inside or applying some lubricant to the grommet in the cone area. You should push at least two thirds of the hose onto the grommet of the connection piece.
5. Push the cutting ring over the hose into the cone area on the grommet of connection piece.
6. Screw the union nut onto the valve of the dosing pump.

✓ **Hose clip connected.**

### 8.4.2 Making the glue-in connection

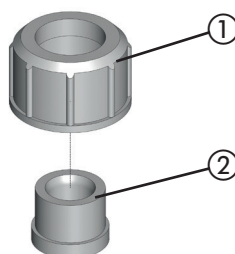

Fig. 12: Glue-in connection

Perform the following working steps:

1. Cut the PVC tube to length.
2. Push the union nut (1) onto the tube.
3. Stick the bonded coupling sleeve (2) to the tube (follow the instructions of the adhesive manufacturer).

4. Screw the union nut onto the valve of the dosing pump. Use a gasket that is suitable for the dosing medium.

✓ **Glue-in connection made.**

### 8.4.3 Making the cemented connection

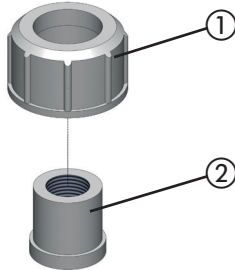

Fig. 13: Cemented connection

Perform the following working steps:

1. Cut the tube to length.
2. Cut the thread (2) onto the end of the tube.
3. Push the union nut (1) onto the tube.
4. Seal the thread. When choosing your sealing material, take into account its resistance to material, temperature and pressure.
5. Screw the union nut onto the valve of the dosing pump. Use a gasket that is suitable for the dosing medium.

✓ **Cemented connection made.**

**i** Under normal conditions, you only need to screw the hydraulic connections finger-tight. However, due to the material settling, the pre-tension of the screw connection can slacken. This means that you must re-tighten the screw connection before carrying out commissioning.

## 8.5 Connecting a leakage drain

Neptune dosing pumps are produced to the highest of quality standards with a long service life. However, some parts are subject to operational wear. This is the case particularly with the diaphragms that are continuously subjected to forces during the suction and discharge strokes and to the effects of the dosing medium.

If a diaphragm ruptures, the dosing medium starts to leak. This leakage is drained via the leakage opening. On the flange of the dosing head, there are three openings for this purpose. Depending on the alignment of the dosing pump, the leakage is drained via the downward opening.

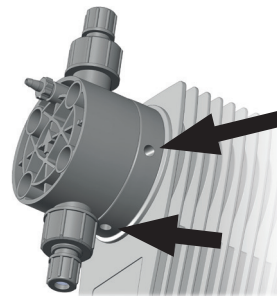

Fig. 14: Openings of the leakage drain



### NOTE

#### Damage to drives due to effervescent media

If a hose is connected to the leakage drain and it is routed back into the dosing tank, effervescent media can enter the drive and damage it.

- ⇒ Collect the leakage in a collecting pan.
- ⇒ As an alternative, you can route the leakage back to the dosing tank using a funnel. You should install the funnel at an adequate distance from the leakage opening.

## 8.6 Connecting the dosing head venting facility

NSP-A and NSP-P dosing heads have an integrated dosing head venting facility (except for dosing heads made of stainless steel).

For the procedure when venting, refer to chapter 11.1.1 "Venting the dosing pump" on page 27.

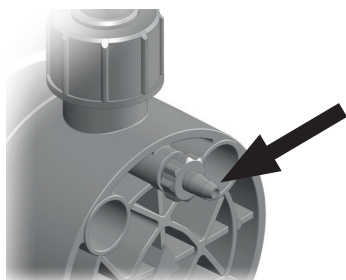

Fig. 15: Dosing head venting facility with hose connection

Perform the following working steps:

1. Connect a 4/6 hose to the dosing head venting facility.
2. Route the other end of the hose into the dosing tank or a collecting tank.

✓ **Dosing head venting facility connected.**

## 8.7 Hydraulic accessories

The following chapter is intended to give you an overview of installation options.

Please note that these operating instructions are no substitute for the instructions supplied with the accessories in each case. The corresponding documentation supplied with the product applies to safety information and provides exact instructions on assembly.

### 8.7.1 Injection nozzle

If the pressure line enters a main line, it is advisable to install an injection nozzle.

Injection nozzles have three main functions:

- Dosing the medium into a main line,
- Preventing flowback into the pressure line through a non-return valve.

Notes on assembly:

- Double-ball injection nozzles must be installed into the main line vertically from the bottom. You can install hose and spring-loaded injection nozzles any way you like.
- With dosing media that tend to crystallize, it is advisable to carry out installation into the main line from the bottom. This prevents air bubbles from being trapped.
- Many dosing media tend to contaminate the injection nozzles, which can lead to blockages. In cases like this, it is advisable to install an injection nozzle that is easy to dismantle and block off.

### 8.7.2 Contact-type water meter

The contact-type water meter measures the throughflow in a pipe and sends a pulse to the dosing pump, which then starts dosing. This means that ideal proportional dosing is also possible with large throughflow fluctuations.

The contact water meter is connected to connection port 2 (see chapter 9.2.2 "Connection socket 3" on page 24).

### 8.7.3 Pressure-relief valve

Pressure relief valves have an important safety function for protecting the dosing pump and the associated pipes and fittings. The dosing pump can generate a pressure that is many times the rated one. A blocked pressure line can lead to dosing medium escaping.

An improperly high pressure can occur if:

- the shut-off valves are closed even though the dosing pump is running,
- pipes block.

At an appropriate pressure, a pressure relief valve opens a bypass line and protects the system in this way from damage caused by over-pressure.

Notes on assembly:

- The line for returning dosing medium from the pressure relief valve must be routed to the dosing tank or to a collecting pan.
- The pressure in the dosing tank must not be too high so that it is possible to accommodate the returned dosing medium.
- As an alternative, the system can return dosing medium into the suction line in front of the dosing pump. In this case, there must not be a non-return valve or a foot valve in the suction line.
- You should install the pressure relief valve as close as possible to the dosing head.

### 8.7.4 Back-pressure valve

Back-pressure control valves are necessary if:

- there are considerably fluctuating system pressures,
- the pressure on the suction side is higher than on the discharge side or if you intend to carry out dosing into depressurized lines.

In cases like this, if you do not use a back-pressure valve, imprecise dosing results will occur or overloading will result. The back-pressure valve solves these problems by generating a defined, constant backpressure.

In some circumstances, a back-pressure valve is unnecessary if you use a hose injection nozzle and if the backpressure that it generates is adequate.

### 8.7.5 Pulsation dampener

Pulsation dampeners have the following functions:

- Damping pulsating delivery flows for processes that require low-pulsation dosing,
- Reducing the throughflow resistance with long pipelines.

When installed on the suction side:

- Damping of acceleration mass forces and with this reduction of wear on the dosing pump.
- Preventing cavitation (pull-off of the liquid column) due to too high acceleration.

However, pulsation dampeners also have important safety functions, since they prevent pressure peaks from arising that lead to piping vibrating and cause them to snap.

This problem can occur:

- with the high amplitudes of the vibrations,
- when using long pipes (the severity of the pulsation increases with the length of the pipe),
- when using rigid piping instead of elastic hoses.

Notes on assembly:

- You should carry out assembly in the direct vicinity of the location where you want to damp the pressure peaks (directly in front of the suction valve or directly behind the pressure valve).
- Pulsation dampeners should be installed with throttle valves or back-pressure valves installed directly behind them. By setting the valves appropriately, you can further-optimize damping of the pulsations.
- To prevent unnecessary pipe friction losses, you should lay the connecting line straight and in accordance with the rated width of the pulsation dampener.
- You must separately fasten relatively large pulsation dampeners and ones with hose connections.
- Pipelines must not transfer any mechanical tensions onto the pulsation dampener.

### 8.7.6 Priming aid

Priming aids are particularly advisable:

- in the case of dosing pumps with small volumetric displacements per stroke or with low stroke length settings,
- with high suction heights,
- with highly dense dosing media,
- at priming for the first time due to dry valves and air in the suction line and the dosing head,
- in dosing systems with frequent downtimes.

Further advantages resulting from priming aids:

- preventing cavitation in the suction line,
- gas removal,
- optical dosing control with small amounts,
- smoothing of the suction flow.

### 8.7.7 Level monitoring

Level monitoring of suction-side feeding of the dosing medium to prevent the tank being sucked dry and to ensure that it can be topped up again in good time.

### 8.7.8 Dosing of suspensions

When dosing suspensions, the dosing head must be rinsed regularly to prevent depositing. To do this, you install a feed line for the rinsing medium (water) in the suction side installation.

### 8.7.9 Suction pressure regulator

A suction pressure regulator may be necessary if the suction-side installation of the system demonstrates a varying suction pressure or supply pressure:

- Dosing pumps that are installed above dosing tanks deliver less as the tank empties, since the suction head increases.
- Dosing pumps that are installed below dosing tanks deliver less as the tank empties, since the positive delivery pressure reduces.

Further problems that can occur:

- Greater wear on the dosing pump, e.g. diaphragm rupture due to the effects of heavy forces with particularly high tanks and high-density dosing media.
- Idling of the dosing tank in the case of a diaphragm rupture or pipe breakage.
- Impermissibly high forces in the pump transmission that occur when dosing pumps receive the dosing medium directly from the pressure line.
- Reduced performance or destruction of fittings due to cavitation with long suction lines.

Installing a suction pressure regulator is a remedy for the problems above. The suction pressure regulator is opened by the dosing pump's suction pressure. This ensures that no dosing medium can flow if the dosing pump is not running or no vacuum can be generated following a pipe fracture.

## 9 Electrical installation

**DANGER**

**Mortal danger from electric shock!**

If there is an electrical accident, you must disconnect the dosing pump from the mains as quickly as possible.

⇒ Install an emergency stop switch or integrate the dosing pump into the plant safety concept.

- The dosing pump must not be operated by switching the mains voltage on or off.
- Signal cables must not be laid parallel to high-voltage current lines or mains cables. You must route supply and signal lines in separate channels. An angle of 90° is required at line crossings.

**CAUTION**

**Danger of automatic start up!**

The dosing pump does not have an ON/OFF switch and may start to pump as soon as it is connected to the mains supply. This means that dosing medium can escape. Depending on the type and hazardousness of the dosing medium, this can result in damage to property or to injury.

⇒ Install an emergency stop switch or integrate the dosing pump into the plant safety concept.

**NOTE**

**Conducting rubber hoses with versions NSP-A and NSP-P**

The NSP-A and NSP-P are delivered with two conducting rubber hoses installed in connection sockets 1 and 3. These conduct electricity and ensure that the contacts in the connection sockets remain closed when no cables are connected. If the conducting rubber bands in connection sockets 1 and 3 are missing or not correctly installed and there are no cables connected to the sockets, it is not possible to start the dosing pump.

⇒ Insert the conducting rubber bands in connection sockets 1 and 3 if there are no cables connected to the connection sockets.

⇒ Ensure that the conducting rubber band is installed on the correct contacts (see instructions in following chapters).

⇒ Retain the conducting rubber hoses so that you can change the assignment of the connection ports later.

**NOTE**

**Damage due to incorrect mains voltage**

The dosing pump can be damaged if you connect it to the wrong mains voltage.

⇒ Observe the information on the mains supply that is given on the rating plate.

**NOTE**

**Insufficient electromagnetic compatibility**

When you connect the dosing pump to a socket without an attached protective earth, it is not possible to guarantee the interference radiation and interference immunity according to EMC regulations.

⇒ Only connect the dosing pump to sockets with an attached protective earth.

### 9.1 Principles

- The dosing pump is fitted with a 115 V AC or 230 V AC (50 / 60 Hz) power supply unit.
- The electrical connection complies with local regulations.
- The dosing pump must be plugged into a grounded power outlet.
- To avoid dosing errors at the end of the process, the dosing pump must be locked electrically.

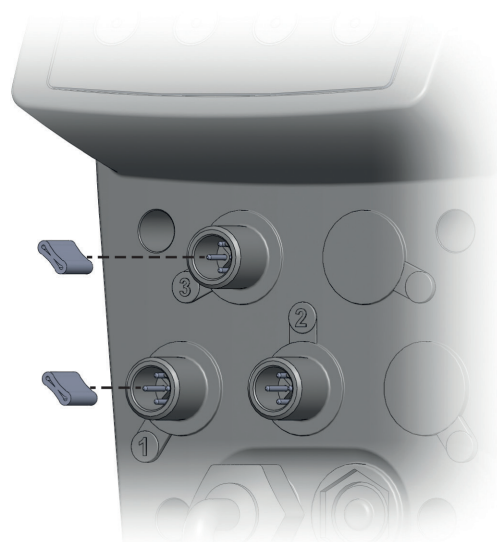

Fig. 16: Conductive rubber hoses in the connections 1 and 3 of the NSP-A and NSP-P



## 9.2 Description of connection sockets

Not all versions of the dosing pump provide all the features described here. Every section heading includes the versions which apply to the section.



Fig. 17: Connection sockets 1 – 3

Inputs	Connection socket
Clearance signal input	1
Analogue or pulse signal input	2
Level signal input	3

Table 15: Inputs of the control unit

### 9.2.1 Connection socket 1

#### 9.2.1.1 Release input

Using the Release input, it is possible to start or stop the dosing pump externally.

To set the function, see section 10.2.3 "Release input" on page 25.

- Potential-free contact
- Connection M12x1 cable with plug connector, A-coded
- Assignment of pin 3, 4

Pin	M12x1 (A-coded)	Assignments	Connection	Cable colour	
1		-	-	Brown	BN
2		-	-	White	WH
3		Ground (GND)	—○3	Blue	BU
4		External On/Off	—○4	Black	BK

Table 16: Connection socket 1

\* Applies to cable colours of cables from Neptune. No liability is accepted for cables from other manufacturers.

### Removing the conductive rubber band

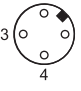

Fig. 18: Conductive rubber band in connection socket 1

Remove the conductive rubber band before inserting the cable in the connection socket.

After the cable has been removed, the conductive rubber band must be reinserted in the connection socket. Insert it between pins 1+2 and 3+4 as shown in Fig. 18.

### Connection socket 2

#### 9.2.1.2 Analogue input (only NSP-A)

The analog input makes it possible to control the delivery capacity by means of a 0/4 – 20 mA signal. The delivery capacity is regulated via the stroke frequency.

- 0/4 – 20 mA Signal
- Invertible
- Current range variable
- Working resistance: 200 Ohm (because of the electronic fuse), not potential-free

Pin	M12x1 (A-coded)	Assignments	Connection	Cable colour	
1	-	-	-	Brown	BN
2		(+) 0/4 – 20 mA	—○2	White	WH
3		Ground (GND)	—○3	Blue	BU
4	-	-	-	Black	BK

Table 17: Connection port 2 - analogue input

\* Applies to cable colours of cables from Neptune. No liability is accepted for cables from other manufacturers.

### 9.2.1.3 Pulse input (only NSP-P)

The pulse input makes it possible to control the delivery capacity by means of pulses. The system regulates the delivery capacity by means of the dosing pump's stroke frequency and number of strokes in dependence on the number of pulses and the pulse spacing.

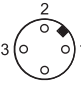
- Provided potential-free contact
- For potential-free NO contact, e.g. a contact-type water meter
- 5 V DC supply voltage (current across all connections limited to a total maximum of 50 mA)
- Pulse length min. 4 ms

Pin	M12x1 (A-coded)	Assignments	Connection	Cable colour	
1		Pulses		Brown	BN
2					
3		Ground (GND)		Blue	BU
4	-	-	-	Black	BK

Table 18: Connection port 2 - pulse input

\* Applies to cable colours of cables from Neptune. No liability is accepted for cables from other manufacturers.

### 9.2.2 Connection socket 3

#### Level input

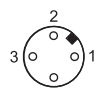
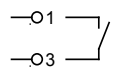
Connection port 3 serves the level monitoring of a dosing tank (e.g. a suction line with a level switch).

- 5 V DC supply voltage (current across all connections limited to a total maximum of 50 mA)
- Alert and main alarm
- Potential-free contact

 A matching connection cable with A-coded plug connector is integrated in the suction lines / level monitoring systems of Neptune. An adapter is required if using older suction lines with a 3.5 mm jack plug. You can find this adapter and additional cables in the Neptune price list.

Pin	M12x1 (A-coded)	Assignments	Connection	Cable colour		
1		Low level alert		Brown	BN	
2		Main alarm			White	WH
3		Ground (GND)			Blue	BU
4	-	-	-	Black	BK	

Table 19: Connection socket 3

\* Applies to cable colours of cables from Neptune. No liability is accepted for cables from other manufacturers.

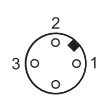
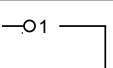

## 10 Control

### 10.1 Operator controls of the control unit

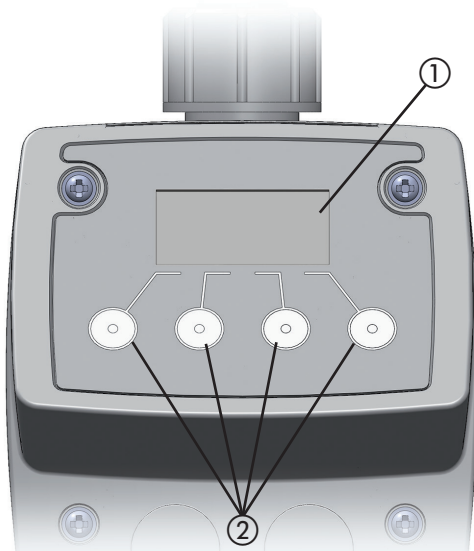

Fig. 19: Operator controls of the control unit

No.	Explanation
1	Graphic display
2	Four multifunction keys

Table 20: Operator controls of the control unit

You operate the dosing pump using the four keys below the display. The system shows the respective functions of the keys at the bottom of the display.

#### 10.2.3 Release input



Symbol	Meaning
	Contact open
	Contact closed

Table 23: Explanation of the menu symbols – Release input

#### 10.2.4 Release code



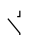



Symbol	Meaning
	Release code active

Table 24: Explanation of the menu symbols – release code

The  and  selection keys as well as the  and  keys have a repeat function, i.e. if you keep them pressed down, the system automatically repeats the key function.

The display brightness reduces 45 seconds after your last input.

 The dosing pump does not have an ON/OFF switch. After being disconnected from the power supply, the dosing pump starts in the operating mode and configuration that you selected last.

### 10.2 Explanation of the menu icons

#### 10.2.1 Level monitoring



Symbol	Meaning
	Dosing tank full
	Dosing tank at minimum (alert)
	Dosing tank empty (main alarm)

Table 21: Explanation of the menu symbols – Level monitoring

#### 10.2.2 Operating modes

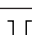

Symbol	Meaning
	Manual mode
	Analogue input (only NSP-A)
	Pulse input (only NSP-P)

Table 22: Explanation of the menu symbols – Operating modes

#### 10.2.5 Activating the password protection

If password protection is activated, the dosing pump is protected against unauthorized access. You can only perform settings after entry of the correct password.





#### WARNING

##### Caustic burns or other burns through dosing media!

If the password protection is activated, operation of the dosing pump is blocked. The only way to stop a dosing pump without entry of the password is via the power supply. In unfavourable cases, if the password protection has been inadvertently activated or the user has forgotten the password, the dosing pump cannot be stopped in time. This can result in injury.

⇒ Install an emergency stop switch or integrate the dosing pump into the plant safety concept.

You can set any password you like from 0001 to 9999.

1. Press  and  simultaneously.
  - ▶ The dosing pump displays the password protection menu.

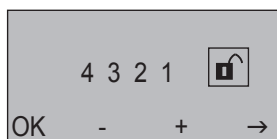







Fig. 20: Release code

2. Use the  and  keys to set a value from 0 to 9 for the first digit of the code and then press .
3. Proceed as described under point 2 for the other digits.
4. Choose the last point  and press .
5. Press **OK**.
  - ▶ The dosing pump now displays the corresponding symbol:

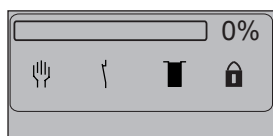

Fig. 21: Start screen with activated password protection

- ✓ **Password protection activated.**

#### 10.2.5.1 Entering the password

Once you press any key, you must enter the password. If you enter the code correctly, you have 120 seconds in which to operate the dosing pump. When the 120 seconds have elapsed, you must re-enter the code, even if you are in the middle of making another entry (this does not include settings in the menus).

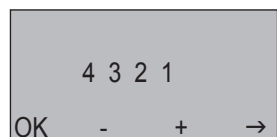



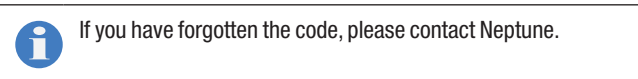







Fig. 22: Entering the Release code

1. Use the  and  keys to set a value from 0 to 9 for the first digit of the code and then press .
2. Proceed as described under point 1 for the other digits.
3. After entering all the digits, press **OK**.
  - ▶ If your input is correct, the dosing pump displays the start screen.



- ✓ **Enter the code.**

#### 10.2.5.2 Deactivating the password protection

1. Press  and  simultaneously.
2. Press  until  is selected.
3. Press .
4. Press **OK**.

- ✓ **Password protection deactivated.**

## 11 Operation

	<b>WARNING</b>
<b>Caustic burns or other burns through dosing media!</b>	
After connecting the mains supply, residual dosing media in the dosing head can spray out.	
⇒ Before connecting the mains supply, connect the dosing lines.	
⇒ Check that all the screw connections have been tightened correctly and are leak-proof.	

	<b>CAUTION</b>
<b>Danger of automatic start up!</b>	
The dosing pump does not have an ON/OFF switch and may start to pump as soon as it is connected to the mains supply. This means that dosing medium can escape. Depending on the type and hazardousness of the dosing medium, this can result in injury.	
⇒ Stop the dosing pump before disconnecting it from the mains supply.	
⇒ Ensure that the dosing pump has been installed correctly before connecting it to the mains supply.	

### 11.1 Commissioning the dosing pump

Precondition for action:

- ✓ The dosing pump was fitted and installed in accordance with the sections "Fitting the dosing pump", "Hydraulic installation" and "Electrical installation".
- ✓ All the mechanical fastenings have been inspected to ensure adequate load-bearing capacity.
- ✓ The dosing head screws have been tightened with the correct torque.
- ✓ All the hydraulic sections have been inspected to ensure they are adequately leak-proof and that the through flow direction is correct.

 For initial commissioning, it is advisable to use water as the dosing medium to check that the system is leak-proof and that the dosing pump is functioning correctly. Check first whether undesirable reactions could occur between the actual dosing medium and the water.

Perform the following working steps:

1. Open the shut-off valves on the suction and discharge sides if present.
2. Plug in the dosing pump's mains plug to the power supply.
3. If the dosing head is fitted with a vent screw, vent the dosing pump (see section 11.1.1 "Venting the dosing pump" on page 27).

4. Select an operating mode and start the dosing pump in accordance with the instructions in the chapter 11.2 "Operating modes" on page 28.
  - ▶ The dosing pump primes. If it does not prime enough, use a priming aid (see chapter 8.7.6 "Priming aid" on page 21).

 At initial commissioning, it is advisable to prime the pump without backpressure. For this purpose, we recommend installing a relief valve on the discharge side of the dosing pump.

- ✓ **The dosing pump is commissioned.**

#### 11.1.1 Venting the dosing pump

Plastic dosing heads are fitted with a vent screw. Gas bubbles can be removed from the dosing head using vent screws, in order to improve the performance of the pump. Whether venting is helpful depends on the dosing medium and the size of the pump.

	<b>CAUTION</b>
<b>Danger of personal injury and material damage!</b>	
Dosing medium can escape if you loosen connections on the dosing head (e.g. for venting) during operation.	
⇒ Use sufficient personal protective equipment.	
⇒ Follow the safety data sheet of the dosing medium.	
⇒ Clean the dosing pump if dosing medium escapes.	
⇒ Dispose of the dosing medium correctly.	

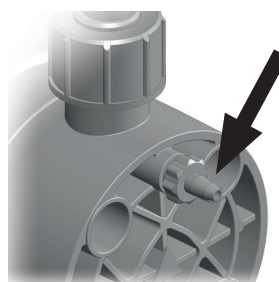

Fig. 23: Dosing head venting facility with vent screw

Precondition for action:

- ✓ The dosing head venting facility connected has been connected in accordance with the chapter 8.6 "Connecting the dosing head venting facility" on page 20.

Perform the following working steps:

1. Select the *Internal* operating mode.
2. Press **Stop**.
3. Keep **+** depressed until 100% delivery capacity is achieved.

4. Open the vent screw by one complete turn (looking onto the dosing head, anti-clockwise).
  5. Press **Start**.
    - ▶ The dosing pump starts delivery at the highest stroke frequency.
  6. Press **Stop**, as soon as there is a continuous throughflow from the dosing head venting facility with no air bubbles.
    - ▶ The dosing pump stops delivery.
  7. Close the vent screw.
- ✓ **The dosing pump is vented.**

 If you are using strongly effervescent dosing media, allow them to flow out continuously. Open the vent screw such that about one drop per 1 – 3 strokes escapes, then close the discharge.

## 11.2 Operating modes

The dosing pump offers the following operating modes:

- *Internal* - Manual setting of the delivery capacity,
- *External* - Controlling the stroke frequency and number of strokes in dependence on the number of pulses and the pulse spacing (NSP-P) or the analogue signal (NSP-A).

### 11.2.1 Internal operation

#### 11.2.1.1 Selecting the operating mode

- Press **Int**.
- ▶ The dosing pump displays the start screen of *Intern mode*.



Fig. 24: Start screen of Manual operation

#### 11.2.1.2 Starting the dosing pump

1. Use the **+** and **-** keys to set the desired stroke frequency.
  2. Press **Start**.
- ✓ **Dosing pump has started.**

#### 11.2.1.3 Stopping the dosing pump

- Press **Stop**.
- ▶ The system displays the "Stop" signal and **Stop** changes to **Start**.
- ✓ **Dosing pump has stopped.**

### 11.2.2 External operation

In *External* mode, the frequency and number of strokes issued by the NSP-P dosing pump is controlled in dependence on the pulse frequency and number of pulses applied at the pulse input (see section 9.2.1.3 "Pulse input (only NSP-P)" on page 24).

The NSP-A is controlled via an analogue signal.

#### 11.2.2.1 Selecting the operating mode

- Press **Ext** to select the operating mode.
- ▶ The dosing pump shows the start display of the operating mode *External*.

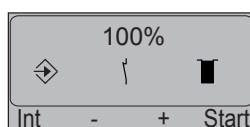



Fig. 25: Parameters of the operating mode

#### 11.2.2.2 Setting the current value for 0% and 100% delivery capacity (only NSP-A)

Perform the following working steps:

1. Press the  key to navigate to the settings menu.
  - ▶ The dosing pump displays the current configuration of the parameters.

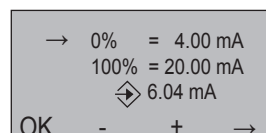



Fig. 26: Configuring the parameters

2. Either select the limit value 0% or 100% using the  button.
  3. Use the **+** and **-** keys to set the desired current value for 0% / 100%. A value between 0.00 - 20.00 mA is permissible. The symbol  shows the current value currently set.
  4. Press OK.
    - ▶ The dosing pump displays the start screen of the operating mode *External* (analogue input).
- ✓ **The current value for 0% and 100% delivery capacity is set.**

#### 11.2.2.3 Setting the transmission and reduction

The transmission and reduction factors can be set in 1% intervals of 1% to 1000%. A set value of 100% means that the dosing pump executes one dosing stroke per incoming pulse signal. For values above 100%, the dosing pump executes more dosing strokes per pulse signal accordingly.

For values below 100%, the dosing pump executes less than one dosing stroke per pulse signal, meaning that several pulse signals are required before a dosing stroke is executed.

The number of pulse signals required for a dosing stroke is displayed on the dosing pump display for values below 100%.

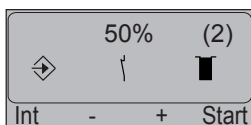

Fig. 27: Number of pulse signals required (here: 2)

Examples for transmission / reduction

Number of pulses	Setting	Dosing strokes
4	25%	1
2	50%	1
1	100%	1
2	100%	2
4	125%	5
1	1000%	10

Table 25: Examples for transmission / reduction of pulse signals

With sequences consisting of successive pulses, it is necessary to ensure that given specific settings, the pulses are not always followed by the number of dosing strokes which correspond to the pulses. This is due to the circumstance that only one whole dosing stroke is performed, and not e.g. half or a quarter of a dosing stroke. Depending on the transmission or reduction factor and the number of pulses, however, there is a possibility of uneven results with "pending" pulse signals. In these cases, the required number of dosing strokes is only achieved after a number of pulse cycles.

Examples:

The dosing pump receives pulses with a reduction factor of 30%. For the first stroke, it requires 4 pulses in this setting (4 x 30% = 120%), as 3 pulses (3 x 30% = 90%) are insufficient for one dosing stroke (= 100%). However, the second dosing stroke is executed after just 3 more pulses, as the stroke buffer of the dosing pump still has 20% pending from the first 4 pulses (120% - 100% = 20%) and this is added to the 3 pulses (90% + 20% = 110%). The third dosing stroke also only requires 3 additional pulses (90% + 10% = 100%). A further 4 pulses are then required for the fourth dosing stroke.

If pulses are transferred to the dosing pump with a transmission factor of 125%, a dosing stroke is executed for each of the first 3 pulses. With the 4th pulse, it executes 2 dosing strokes (3x 25% pending from the first 3 pulses + 125% = 200%).

The dosing pump has a dynamic stroke buffer which includes the interval between the pulses in the calculation and adjusts the distribution of the dosing strokes accordingly.

#### 11.2.2.4 Calculating the transmission factor

The dosing pump NSP-P has a defined stroke volume per dosing stroke. If a certain dosing quantity is required per pulse, the corresponding transmission factor can be calculated for the external operating mode.

If you have no Internet connection, you can also perform the calculation yourself.

The following parameters are required for this:

- required dosing quantity in ml/pulse
- delivery capacity of the dosing pump in ml/stroke

The delivery capacity of the dosing pump can be taken from in the technical data and the delivery characteristic curves (see "delivery capacity data" on page 13 and "delivery characteristic curves" on page 46). Intermediate values can be interpolated.

Calculate the value using the following formula:

$$\frac{\text{required dosing quantity per pulse} \times 100\%}{\text{delivery capacity per stroke}}$$

Example: With a NSP-P164, 1 ml should be proportionally dosed per pulse. The stroke volume at 58 psig is 0.63 ml.

The factor to be set is calculated as follows:

$$\frac{1 \text{ ml/pulse} \times 100}{0,63 \text{ ml/stroke}} = 159 \%$$

In this example, the pump would execute 159 strokes for 100 incoming pulses.

**i** Note that the stroke frequency of the dosing pump is restricted. For the NSP-P164, the max. stroke frequency is approx. 180 strokes/min. Any additional incoming strokes are not processed.  
For this example, this means that the dosing pump can process a maximum of 113 pulses/min (180/1.59).

#### 11.2.2.5 Starting the dosing pump

Precondition for action:

- ✓ The dosing pump has been connected in accordance with the chapter "Pulse input (only NSP-P)" on page 24.

1. Press **Start**.
2. Supply pulses to the pulse input of the dosing pump.

✓ **Dosing pump has started.**

#### 11.2.2.6 Stopping the dosing pump

➔ Stop the incoming pulses or press **Stop**.

✓ **Dosing pump has stopped.**

#### 11.2.2.7 Operation with contact water meter (only NSP-P)

The dosing pump NSP-P is prepared for operation with a contact-type water meter. The contact sequence of the water meter and the size of the dosing pump must be matched to each other (calibrated).

**Preselection of the dosing pump size**

You can use the following diagram to determine the necessary size of the dosing pump depending on the intended dosing quantity and the existing or selected pulse sequence of the contact-type water meter. Comparison with the technical data of the dosing pump with regards to the operating pressure is also necessary (see “Technical data” on page 13).

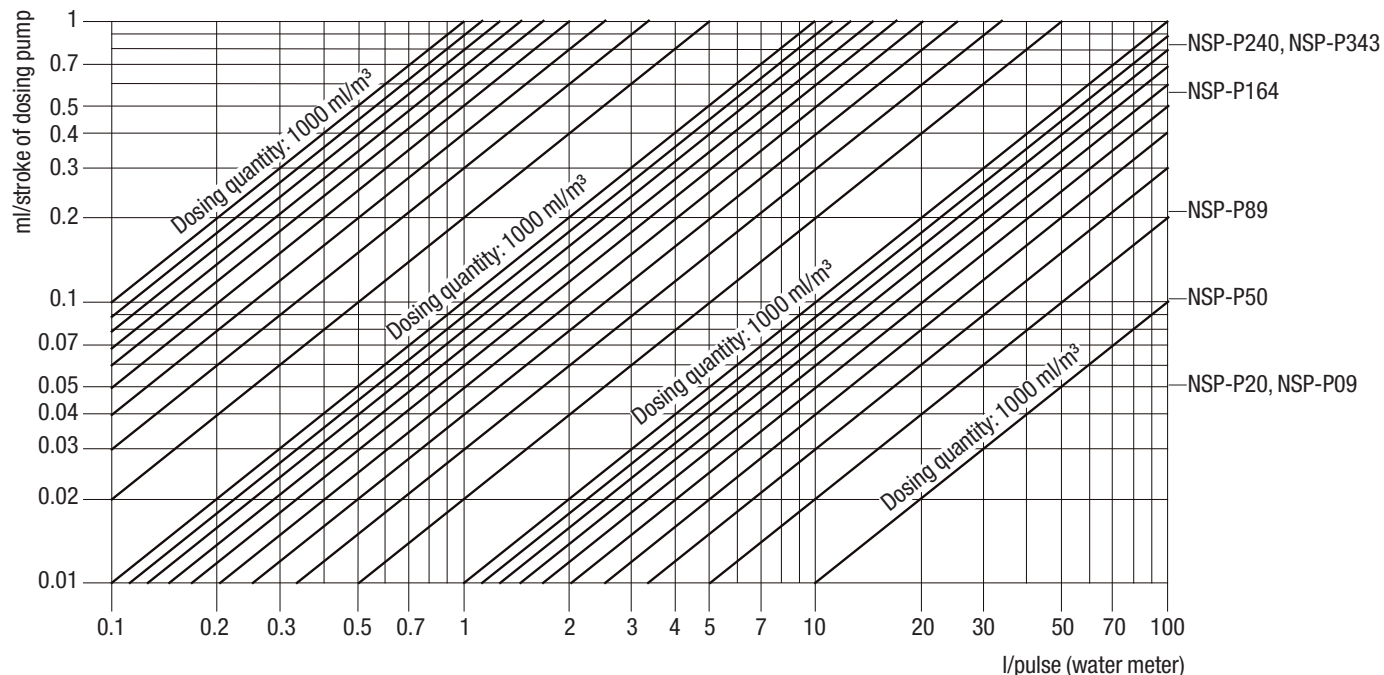

### Calculating the transmission factor

The first calculation phase is used to determine the transmission factor which is set in the display of the NSP-P.

The following parameters are required for this:

- Dosing quantity per cubic metre of water in ml/m<sup>3</sup>
- Pulse sequence of water meter in l/Imp
- Delivery capacity per stroke of the dosing pump in ml/stroke

Calculate the factor using the following formula:

$$\frac{\text{required dosing quantity} \times \text{pulse sequence of water meter}}{\text{delivery capacity per stroke} \times 10}$$

Example:

1000 ml of a dosing medium should be dosed per m<sup>3</sup> of water in a water line at 58 psig. The contact-type water meter has a pulse sequence of 1 l/pulse. The selection table (see 30) can be used to select a NSP-P164 with 0.63 ml/stroke at 58 psig. A NSP-P240 would also come into consideration as it doses 0.88 ml/stroke. A NSP-P343 is not suitable as it can only work at 43.5 psig.

The factor to be set is calculated as follows:

$$\frac{1000 \times 1}{0,63 \times 10} = 159 \%$$

### Calculating the necessary stroke frequency

The second calculation phase checks the size of the contact-type water meter and the maximum stroke frequency of the NSP-P by comparing the required stroke frequency and the maximum stroke frequency of the dosing pump.

The following additional parameter is required for this:

- The nominal size of the contact-type water meter in cubic metres per hour [m<sup>3</sup>/h]

Calculate the necessary stroke frequency using the following formula:

$$\frac{\text{dosing quantity in ml/m}^3 \times \text{nominal size of the water meter in m}^3/\text{h}}{\text{delivery capacity per stroke in ml/stroke}}$$

Example:

For the dosing specified above, a contact-type water meter with the nominal size of m<sup>3</sup>/h should be used.

The necessary stroke frequency is calculated with:

$$\frac{1000 \text{ ml/m}^3 \times 5 \text{ m}^3/\text{h}}{0,63 \text{ ml/stroke}} = 7937 \text{ strokes/h}$$

This value is compared with the maximum possible stroke frequency of the dosing pump. The NSP-P164 achieves a maximum of 10800 strokes/hour.

Result:

The required stroke frequency must be smaller than the maximum stroke frequency of the dosing pump, which is the case here.

If the maximum stroke frequency is higher, the dosing pump cannot continue up to the water meter's maximum flow rate. In this case, the following versions are possible:

- Use of a higher dosing pump model, e.g., NSP-P240 instead of NSP-P164
- Reduction of the dosing quantity via higher concentration of the dosing medium
- Increase of the pulse sequence of the contact-type water meter, e.g., 0.5 l/pulse instead of 1 l/pulse

### 11.3 External On / Off via Release input

Regardless of the selected operating mode, you can start or stop the dosing pump by means of the closed switching contact on the Release input.

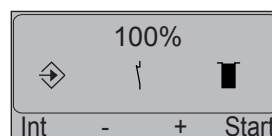

Fig. 28: Start screen of external operation with symbol for closed contact in centre

#### 11.3.1 Starting the dosing pump

- ➔ Close the switching contact on the Release input.
- ✓ **Dosing pump has started.**

#### 11.3.2 Stopping the dosing pump

- ➔ Open the switching contact on the Release input.
- ✓ **Dosing pump has stopped.**

 No alarm follows the external switch-off of the dosing pump.

### 11.4 Decommissioning the dosing pump

Perform the following working steps:

1. Stop the dosing pump in accordance with the selected operating mode.
  2. Unplug the dosing pump's mains plug from the power supply.
  3. Disconnect all electrical connections.
  4. Depressurize all the hydraulic parts in the system.
  5. Unplug all the hydraulic connections on the dosing pump.
  6. Empty the dosing head.
  7. Remove any residual dosing medium from the dosing head by flushing the system with a washing agent. Ensure that the washing agent is compatible with the dosing medium.
- ✓ **Dosing pump is decommissioned.**



## 11.5 Shutting down in an emergency

- In an emergency, you must immediately disconnect the dosing pump from the mains supply or activate the Emergency Stop switch installed in the system.
- Depending on the type of incident, you must depressurized the hydraulic connections or locked to prevent dosing medium from escaping.
- You must follow the safety data sheet of the dosing medium.

## 11.6 Storage

Storing the dosing pump correctly extends its service life. You should avoid negative influences such as extreme temperatures, high humidity, dust, chemicals, etc.

Ensure ideal storage conditions where possible:

- the storage place must be cold, dry, dust-free and generously ventilated,
- Temperatures between + 35.6 °F and + 104 °F (for PP and PVDF dosing heads, between + 35.6 °F and + 140 °F),
- Relative air humidity must not exceed 90 %.

## 11.7 Transportation

Perform the following working steps:

- The unit should be thoroughly cleaned. Any dangerous dosing media must be additionally neutralised and decontaminated.
- All accessories should be dismantled.
- All openings should be closed, so that no foreign objects can get into the system.
- The dosing pump must be suitably packed, preferably in the original packing, for transportation.

## 11.8 Disposal of old equipment

- The waste unit must be thoroughly cleaned. Any dangerous dosing media must be additionally neutralised and decontaminated.
- Any residual dosing media must be removed in a professional manner.
- The dosing pump must be disposed of in accordance with applicable local laws and regulations. The device does not belong to household waste!
- As the disposal regulations may differ from country to country in the European Union, please consult your supplier if necessary. In Germany, the manufacturer must provide free-of-charge disposal provided the unit has been sent in a safe manner.





## 12 Maintenance

The products are produced to the highest quality standards and have a long service life. Nevertheless, some of their parts are subject to wear due to operation (e.g. diaphragms, valve seats, valve balls). This means that regular visual inspections are necessary to ensure a long operating life. Regular maintenance will protect the dosing pump from operation interruptions.

	<b>DANGER</b>
<p><b>Mortal danger from electric shock!</b></p> <p>Live parts can inflict fatal injuries.</p> <ul style="list-style-type: none"> <li>⇒ Before carrying out any maintenance work, always disconnect the dosing pump from the power supply.</li> <li>⇒ Secure the dosing pump from accidental power-up.</li> </ul>	

	<b>WARNING</b>
<p><b>Caustic burns or other burns through dosing media!</b></p> <p>While working on the dosing head, valves and connections, you may come into contact with dosing media.</p> <ul style="list-style-type: none"> <li>⇒ Use sufficient personal protective equipment.</li> <li>⇒ Rinse the dosing pump with a medium (e.g. water) which does not pose any risk.</li> <li>⇒ Release pressure in hydraulic parts.</li> <li>⇒ Never look into open ends of plugged pipelines and valves.</li> </ul>	

	<b>WARNING</b>
<p><b>Danger of automatic start up!</b></p> <p>The dosing pump does not have an ON/OFF switch and may start to pump as soon as it is connected to the mains supply.</p> <p>After connecting the mains supply, residual dosing media in the dosing head can spray out.</p> <ul style="list-style-type: none"> <li>⇒ Before connecting the mains supply, connect the dosing lines.</li> <li>⇒ Check that all the screw connections have been tightened correctly and are leak-proof.</li> </ul>	

	<b>CAUTION</b>
<p><b>Danger of personal injury and material damage!</b></p> <p>The dosing pump can generate a pressure that is many times the rated one. The dosing medium can escape in the case of material failure or wear on the dosing head, the connection pipe or the seals that are used.</p> <ul style="list-style-type: none"> <li>⇒ Carry out maintenance work at the recommended intervals.</li> </ul>	

### 12.1 Maintenance intervals

This table gives you an overview of maintenance work and the intervals at which you must carry it out. The next few sections contain instructions for carrying out this work.

Maintenance work to be carried out	Frequency
Check that piping is seated firmly	Regularly
Check that suction and pressure valves are seated firmly	Regularly
Clean suction and pressure valves	Regularly
Check that electrical connections are not damaged	Regularly
Tighten up dosing head bolts	<ul style="list-style-type: none"> <li>■ Regularly</li> <li>■ Before initial commissioning</li> <li>■ After each diaphragm change</li> </ul>
Check diaphragm for leakage due to rupture	Regularly (as long as no leak monitoring system is installed)
Check that the installed accessories are functioning correctly	Regularly
Check the dosing pump for unusual noises during operation, unusual temperatures or smells	Regularly
Replace parts that are subject to wear (diaphragms, valves, seals, etc.)	When unacceptable levels of wear are detected
Rinse out and clean the dosing pump	<ul style="list-style-type: none"> <li>■ Before changing diaphragms</li> <li>■ Before taking out of service for a long period of time</li> <li>■ After feeding aggressive, sticky, crystallising or contaminated liquids</li> </ul>

Table 26: Maintenance information and maintenance intervals

### 12.2 Tighten up dosing head bolts

➔ Tighten the dosing head bolts in diagonally opposite sequence with a torque wrench.

The necessary torque is 16 lbf in.

## 12.3 Change the diaphragm

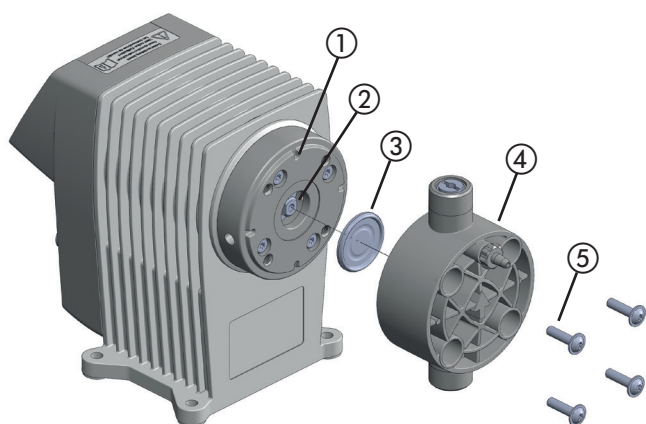

Fig. 29: Exploded view of the diaphragm and dosing head

### 12.3.1 Remove the old diaphragm

Precondition for action:

- ✓ You have disconnected the dosing pump from the mains supply.
- ✓ You have depressurised the hydraulic sections of the plant.
- ✓ You have rinsed the dosing pump using a safe medium (e.g. water).

Perform the following working steps:

1. Screw out the four screws (5) on the dosing head using a suitable tool (SW 3 Allen key) and take off the dosing head (4).
2. Use pliers to bend the edge of the diaphragm (3) slightly upwards and screw it out counter-clockwise.

### 12.3.2 Install a new diaphragm

Precondition for action:

- ✓ You have thoroughly cleaned the diaphragm rod (2) and the diaphragm flange (1) so that the new diaphragm is not affected by dosing medium residues.
  - ✓ The diaphragm (3) thread was lightly greased (e.g. Molycote Longterm W2).
1. Screw the diaphragm manually (3) in the clockwise direction until it safely contacts into the diaphragm rod.
  2. Bring the dosing head into position and insert the screws. First tighten the screws finger-tight. After this, tighten the bolts on the diagonal, e.g. top left – bottom right – top right – bottom left.



### NOTE

#### Damage to the dosing head/diaphragm leaks

If you tighten the screws too much, this can lead to the dosing head being damaged. However, not tightening the screws enough leads to the diaphragm being leaky and correct functioning being affected.

⇒ Tighten the screws to a torque of 16 lbf in.

✓ **Diaphragm change finished.**

## 12.4 Clean suction and pressure valves

Contaminated valves affect the dosing precision and this means that you should clean the valves on a regular basis.

With dosing heads made of plastic, when replacing a valve you must replace the complete dosing head (see chapter 14 "Spare parts" on page 38).

## 13 Troubleshooting

See below for information about how to rectify faults on the device or the system. If you cannot eliminate the fault, please consult with the manufacturer on further measures or return the dosing pump for repair.

### 13.1 Dosing pump not delivering or output too low

Possible cause	Remedy
Wrong type of dosing pump selected	→ Check the dosing pump's technical data and if necessary select a type with a higher delivery capacity.
Valve leaking or blocked	→ Clean the valve and vent the dosing pump. → Tighten the screw connections.
Valve installed incorrectly	→ Reassemble the valve. Ensure that the valve balls are located above the valve seats.
Valve damaged (e.g. valve balls)	→ Remove the damaged parts or install a new valve.
Suction line is leaking	→ Seal the leak locations or replace the parts.
Suction line is blocked (e.g. screen in foot valve)	→ Clean the suction line.
Shut-off valves closed	→ Open the shut-off valves. Inspect the dosing pump for possible damage.
Suction head too high	→ Set the dosing pump to feed or reduce the suction head. → Install a priming aid.
Viscosity too high	→ Possibly reduce the concentration of the dosing medium or increase the temperature. → Install spring-loaded valves. → Increase the pipe diameter.
Current supply interrupted	→ Reconnect the current supply
The dosing pump's electrical data does not match that of the mains supply	→ Check the electrical installation.
System backpressure too high (measured at discharge connection of dosing pump)	→ Clean blocked injection nozzle. → Install pulsation dampeners to reduce pressure peaks if pipes are too long. → Check function of safety valves.

Table 27: Type of fault: Dosing pump not delivering or output too low

Possible cause	Remedy
Conductive rubber bands not inserted in connection sockets or not inserted correctly	→ Insert conductive rubber bands correctly

Table 27: Type of fault: Dosing pump not delivering or output too low

### 13.2 Dosing pump does not prime

Possible cause	Remedy
Valve leaking or blocked	→ Clean the valve and vent the dosing pump. → Tighten the screw connections.
Valve installed incorrectly	→ Reassemble the valve. Ensure that the valve balls are located above the valve seats.
Valve damaged (e.g. valve balls)	→ Remove the damaged parts or install a new valve.
Suction line is leaking	→ Seal the leak locations or replace the parts.
Suction line is blocked (e.g. screen in foot valve)	→ Clean the suction line.
Shut-off valves closed	→ Open the shut-off valves. Inspect the dosing pump for possible damage.
Suction head too high	→ Set the dosing pump to feed or reduce the suction head. → Install a priming aid.
Viscosity too high	→ Possibly reduce the concentration of the dosing medium or increase the temperature. → Install spring-loaded valves. → Increase the pipe diameter.
Current supply interrupted	→ Reconnect the current supply
Dry the valves	→ Dampen the dosing head and the valves → Vent the dosing head.
Air in the suction line with simultaneous pressure on the pressure valve	→ Vent the dosing head or the lines.

Table 28: Type of fault: Dosing pump does not prime

### 13.3 Delivery rate varies

Possible cause	Remedy
Valve leaking or blocked	<ul style="list-style-type: none"> <li>➔ Clean the valve and vent the dosing pump.</li> <li>➔ Tighten the screw connections.</li> </ul>
Valve damaged (e.g. valve balls)	➔ Remove the damaged parts or install a new valve.
Suction line is leaking	➔ Seal the leak locations or replace the parts.
Suction line is blocked (e.g. screen in foot valve)	➔ Clean the suction line.
Viscosity too high	<ul style="list-style-type: none"> <li>➔ Possibly reduce the concentration of the dosing medium or increase the temperature.</li> <li>➔ Install spring-loaded valves.</li> <li>➔ Increase the pipe diameter.</li> </ul>
The dosing pump's electrical data does not match that of the mains supply	➔ Check the electrical installation.
Suction side pressure too high (pump siphoning)	➔ Install a back-pressure valve in the pressure line.
Pressure peaks due to acceleration with long suction lines	➔ Install a suction pressure regulator.
Imprecise dosing due to changeable positive and negative suction heads.	➔ Install a suction pressure regulator.
System backpressure too high (measured at discharge connection of dosing pump)	<ul style="list-style-type: none"> <li>➔ Clean blocked injection nozzle.</li> <li>➔ Install pulsation dampeners to reduce pressure peaks if pipes are too long.</li> <li>➔ Check function of safety valves.</li> </ul>

Table 29: Type of fault: Delivery rate varies

### 13.4 No stroke movement observed

Possible cause	Remedy
Spring plate broken.	➔ Contact the manufacturer.
Current supply interrupted	➔ Reconnect the current supply
The dosing pump's electrical data does not match that of the mains supply	➔ Check the electrical installation.
Pressure peaks due to acceleration with long suction lines	➔ Install a suction pressure regulator.

Table 30: Type of fault: No stroke movement observed

Possible cause	Remedy
System backpressure too high (measured at discharge connection of dosing pump)	<ul style="list-style-type: none"> <li>➔ Clean blocked injection nozzle.</li> <li>➔ Install pulsation dampeners to reduce pressure peaks if pipes are too long.</li> <li>➔ Check function of safety valves.</li> </ul>

Table 30: Type of fault: No stroke movement observed

### 13.5 Dosing pump delivery rate too high

Possible cause	Remedy
Suction side pressure too high (pump siphoning)	➔ Install a back-pressure valve in the pressure line.
Pressure peaks due to acceleration with long suction lines	➔ Install a suction pressure regulator.

Table 31: Type of fault: Dosing pump delivery rate too high

### 13.6 Diaphragm is torn or tears too often

Possible cause	Remedy
Shut-off valves closed	➔ Open the shut-off valves. Inspect the dosing pump for possible damage.
Pressure peaks due to acceleration with long suction lines	➔ Install a suction pressure regulator.
The materials are not suitable for the dosing medium being used	➔ Check the resistance of the materials.
Diaphragm not screwed up to the end stop on the diaphragm rod	➔ Screw a new diaphragm up to the end stop.

Table 32: Type of fault: Diaphragm is torn or tears too often

Possible cause	Remedy
System backpressure too high (measured at discharge connection of dosing pump)	<ul style="list-style-type: none"> <li>➔ Clean blocked injection nozzle.</li> <li>➔ Install pulsation dampeners to reduce pressure peaks if pipes are too long.</li> <li>➔ Check function of safety valves.</li> </ul>
Media sediment in dosing head	➔ Clean the dosing head.

Table 32: Type of fault: Diaphragm is torn or tears too often

### 13.7 Loud noises on the dosing pump

Possible cause	Remedy
The drive magnet's stop damper is worn-out	➔ Contact the manufacturer.

Table 33: Type of fault: Loud noises on the dosing pump

## 14 Spare parts

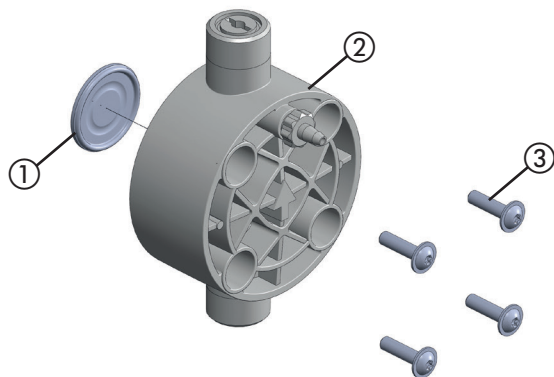

Fig. 30: Spare parts set

Required sets for a complete service:

- 1 diaphragm spare parts kit,
- 1 dosing head spare parts set including valves.

### 14.1 Diaphragm spare parts kits

Diaphragm spare parts set containing:

- 1 Diaphragm (item 1)
- 1 set of dosing head screws (item 3),

Diaphragm kit	Type	Part No.
	09, 20	NSP001
	50, 89	NSP002
	164, 240, 343	NSP003

### 14.2 Dosing head spare parts kits including valves

Spare parts set: dosing head including screws consisting of:

- Dosing head (item 2),
- Valves,
- 1 set of dosing head screws (item 3),

PVC	Type	Part No.
Ceramic/PVDF/FPM (ball/seat/seals)	09, 20	PVC001
	50, 89	PVC002
	164, 240, 343	PVC003

PP	Type	Part No.
Ceramic/PVDF/FPM (ball/seat/seals)	09, 20	PP0001
	50, 89	PP0002
	164, 240, 343	PP0003

PVDF	Type	Part No.
PTFE/PVDF/FPM (ball/seat/seals)	09, 20	PVDF01
	50, 89	PVDF02
	164, 240, 343	PVDF03



Further sets in numerous material combinations can be found in the manufacturer's current price list.

### Other spare parts

PVC	Part No.
Set of conductive rubber bands (2 pcs)	BAND02
Set of covering caps M12x1 (3 pcs)	CAPS03

## 15 Delivery characteristic curves

This Chapter is intended to give you an idea of the delivery capacity that the dosing pump can achieve at specific back pressures. These delivery capacities were determined on the manufacturer's test stands. They apply at 68 °F for water, at 100 % stroke frequency. The delivery capacity depends on the medium (density and viscosity) and temperature. Since these conditions vary at every installation location, you should calibrate the dosing pump.

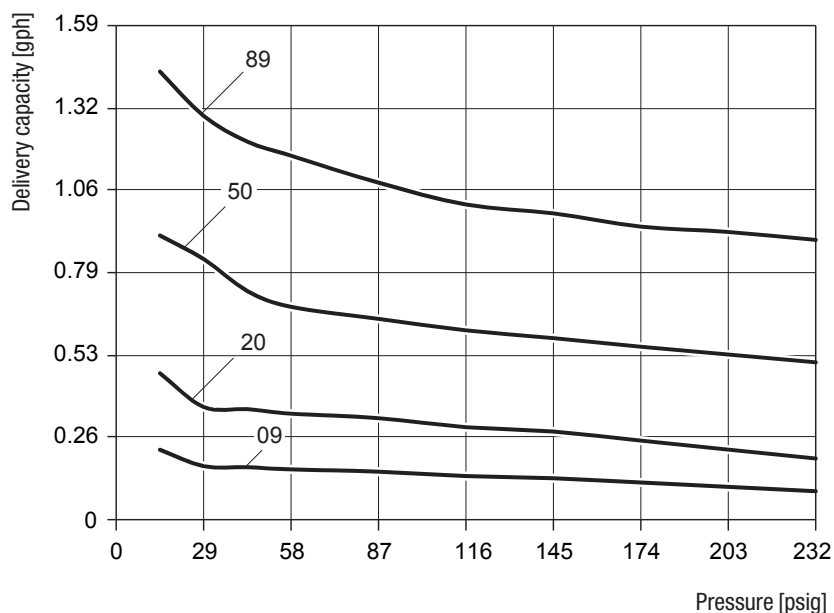

Fig. 31: Delivery characteristic curves NSP A/P 09 through 89

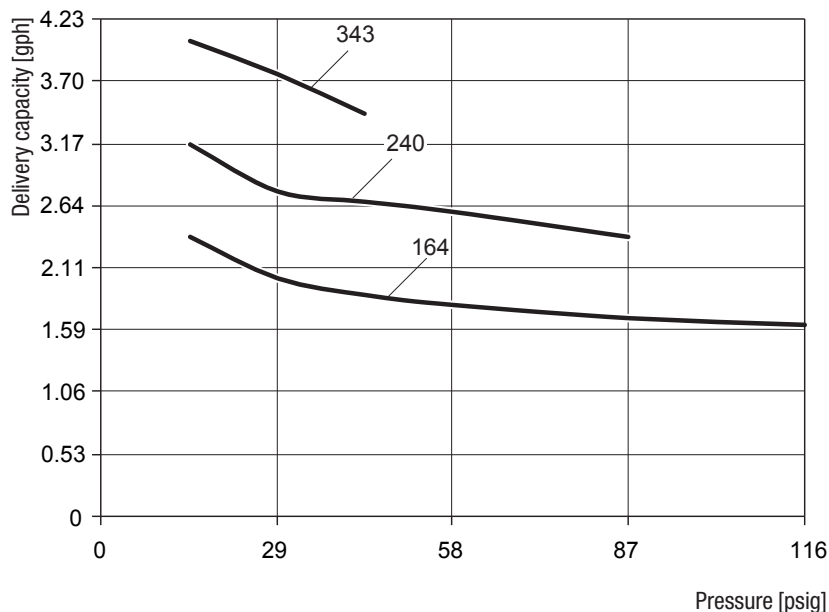

Fig. 32: Delivery characteristic curves NSP A/P 164 through 343

**16 Index**

<b>A</b>		
Accessories .....	20	
Analog input		
Connection .....	23	
Approved media temperature .....	14	
<b>B</b>		
Back-pressure valve .....	20	
<b>C</b>		
Cemented connection .....	19	
Clean suction and pressure valves .....	34	
Commissioning the dosing pump .....	27	
Connection sockets .....	23	
Contact water meter .....	20	
Control .....	25	
Control elements .....	12	
<b>D</b>		
Decommissioning the dosing pump .....	31	
Delivery capacity data .....	13	
Delivery characteristic curves .....	38	
Design of the system .....	17	
Device revision .....	9	
Diaphragms		
Replace .....	34	
Spare parts set .....	37	
Dimensioned drawings .....	15	
Dimensions .....	15	
Disposal of old equipment .....	32	
Dosing head		
Alignment .....	18	
Design .....	11	
Spare parts .....	37	
Dosing head venting facility .....	20	
Dosing media		
Approved media temperature .....	14	
Prohibited dosing media .....	9	
<b>E</b>		
Electrical specifications .....	14	
<b>F</b>		
Foreseeable misuse .....	9	
Function description .....	12	
<b>G</b>		
General warnings .....	6	
Glue-in connection .....	19	
<b>H</b>		
Handling instructions		
Marking .....	5	
Hazards due to non-compliance with the safety instructions .....	7	
Hydraulic accessories .....	20	
Hydraulic connections .....	18	
Hydraulic installations .....	17	
<b>I</b>		
Injection nozzle .....	20	
Inputs of the control unit .....	23	
Installation .....	16	
hydraulic .....	17	
Installing the Dosing Pump .....	16	
Intended purpose .....	9	
Intended use .....	9	
<b>L</b>		
Leakage drain .....	19	
Level monitoring .....	21	
<b>M</b>		
Maintenance .....	33, 37	
Maintenance intervals .....	33	
<b>N</b>		
Notes for the Reader .....	4	
<b>O</b>		
Operating conditions and limits .....	13	
Operating modes .....	28	
Explanation of the icons .....	25	
Operation .....	27, 33	
Operator controls of the control unit .....	25	
<b>P</b>		
Personnel qualification .....	7	
Pressure-relief valve .....	20	
Priming aid .....	21	
Product description .....	11	
Product warranty .....	9	
Prohibited dosing media .....	9	
Pulsation dampener .....	20	
Pulse input		
Connection .....	24	
<b>R</b>		
Rating plate .....	12	
Release code .....	25	
Release input .....	23	
<b>S</b>		
Safety .....	6	
Scope of delivery .....	11	
Set up information .....	16	
Shutdown .....	31, 33	
Shutting down in an emergency .....	32	
Signal words		
Explanation .....	4	
Spare parts .....	37	



Specialist staff .....8  
 Start-up .....22, 27  
 Storage .....32  
 Structure of the dosing pump .....11  
 Suction pressure regulator .....21  
 Suspensions .....21  
 System piping .....17

**T**

Technical data .....13  
 Temperatures  
     Approved ambient temperature .....13  
     Approved media temperature .....14  
 Tighten up dosing head bolts .....33  
 Transportation .....32  
 Troubleshooting .....35

**V**

Venting .....27  
 Venting the dosing pump .....27

**W**

Wall bracket .....16  
 Wall mounting .....16  
 Warnings  
     General warnings .....6  
     Marking .....4  
 Warning sign  
     Explanation .....4  
 Water meter .....20  
 Working in a safety-conscious manner .....7





